



en 2026

IceToolz[®]

2026 Contents

01-02 What's New	14-15 Chain Tools	30-31 Multi Tools
03 Headset Wrenches	16-17 Freewheel & Cassette Tools	32-34 Air Pumps
04 Pedal and Axle Wrenches	17 Cone Wrenches	34-37 Cleaning & Lubrication
05-06 Crank & Chainring Tools	18-20 Wheel Service	38-39 Repair Stands
07 Bottom Bracket Tools	21-22 Tire Service	40-41 Tool Kits
08-10 Frame & Fork Tools	23 Torque Wrenches	42-43 Display & Storage
11 Cable Tools	24-27 General Tools	44 Safety
12-13 Brake Tools	28-29 Hex and Star (Torx®) Wrenches	44 Accessories

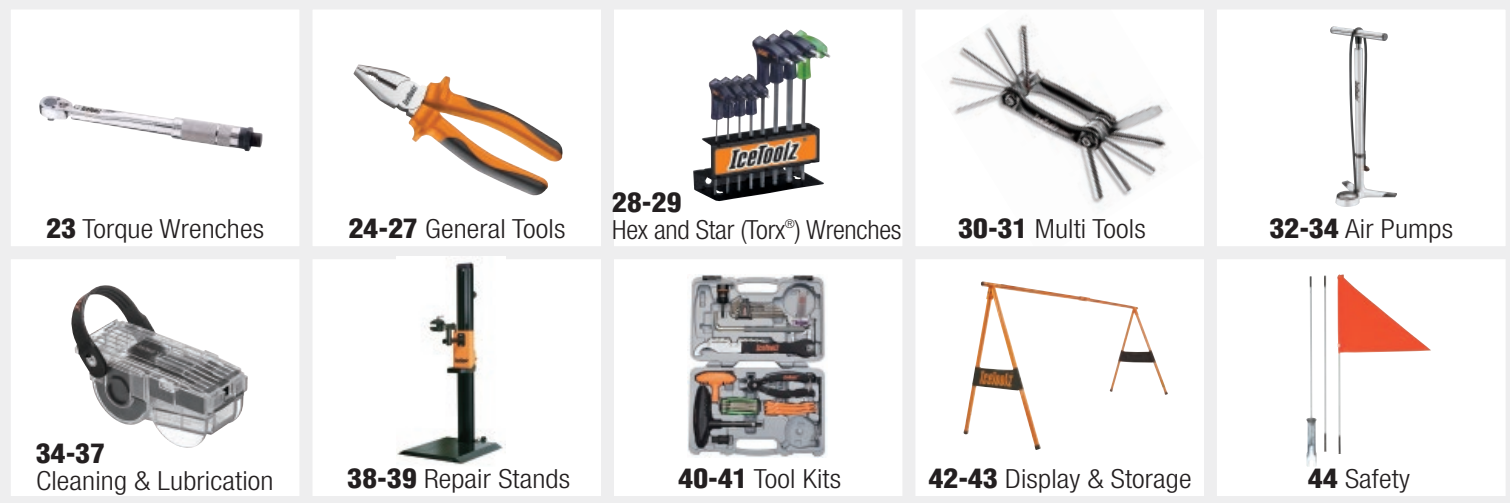

Third party brand / product names used herein are used to identify such products and are for descriptive purposes only. Such names may be marks and / or registered marks of their respective owners.

Online Video ▶ ▶ ▶ ▶ ▶ ▶ ▶



2026 What's New

E282 & E283 High-Grade HSS Durability

Premium HSS resists wear and supports long-term workshop reliability



Restore thru-axle dropouts with confidence

This tap set quickly repairs damaged dropout threads with precise alignment and durable HSS steel



Engineered cutting profile

Precision tap geometry ensures accurate thread engagement and clean results

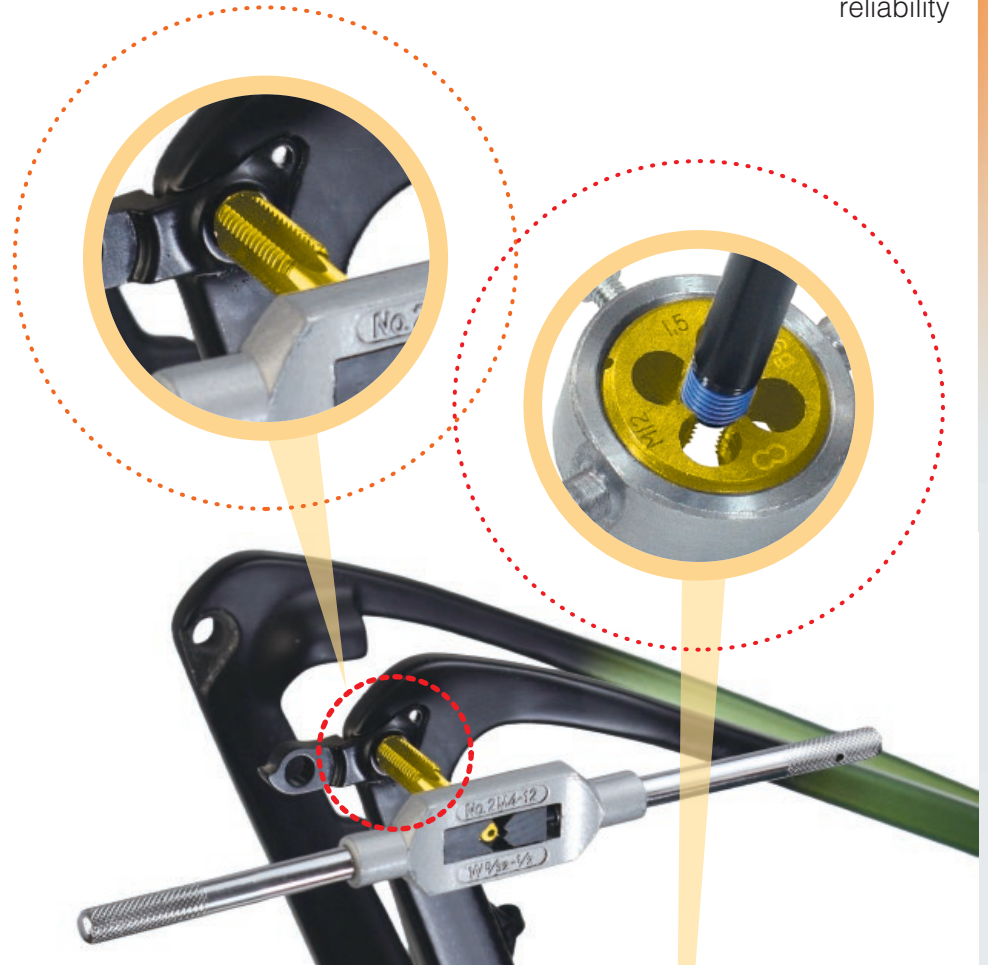

E282 Thru-Axle Dropout Tap Set

Stable, controlled operation

Guided alignment protects valuable dropout and axle threads during repair

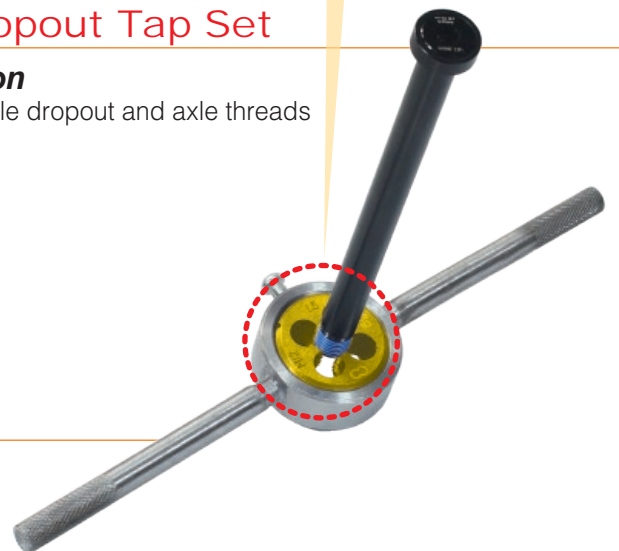

E283 Thru-Axle Die Set

Stable, controlled operation

Guided cutting keeps alignment true and prevents additional thread damage



Restore costly thru-axes with confidence

This die set restores damaged thru-axle threads accurately with durable HSS steel.



Engineered cutting profile

Precision die geometry delivers clean, accurate thread restoration

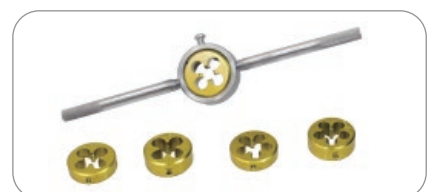

Secure and comfortable

Robust handle provides steady torque and confident operation



E633 = PART ① + ②



E633 SuperLifter-III Repair Stand

Use a two-box packaging layout to lower per-box weight and simplify transport. Updated from SuperLifter-III Repair Stand E633.

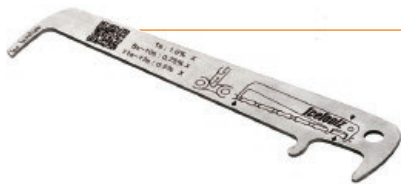

62C5 Chain Checker

True wear isolation

62C5 utilizes a 3-point system to cancel out roller float and pin size tolerances, ensuring the reading reflects actual pin stretch rather than just mechanical play. Updated from 62C4.



Drivetrain economy

Prevents the financial waste of replacing chains too early while protecting your cassette and chainrings from the damage of checking too late.



54R3M

Bleed Kit for Shimano® Break System



06C3 5-in-1 Headset Wrench

- 30 x 32 x 36mm headset wrench
- Freewheel turner
- Lockring tool



06F2 32mm Headset Wrench



06H8 4-in-1 Headset Wrench

- 30 x 32 + 36 x 40mm headset wrench



E148 Headset Cup / BB Cup Press Tool

- For 29.9, 33.9, 36.8, 40.9, 43.8, 46.7, 51.7, 54.8mm headset cups
- For Press-Fit system 22/ 24/ 30mm I.D. bearings
- Max working length of 210mm



M100 Headset Lock Nut Installation Tool - 30mm

M106 Headset Lock Nut Installation Tool - 36mm

M127 Headset Head Cup Installation Tool - 47mm

33S1 15mm Pedal Wrench

- Offset design.
- Ergonomic handle with long anti-slip grip.
- 3/8" square hole for use with a torque wrench to prevent damage to parts.

34S2 Tool for Single Speed Chain Whip, Pedal, Lockring

- Lockring tool
- Freewheel turner (chain whip, 1/2" x 1/8")
- 15mm pedal wrench
- Perfect tool for single-speed bikes

34S4 Tool for Multi Speed Chain Whip, Pedal, Lockring

- Lockring tool
- Freewheel turner (chain whip, 1/2" x 3/32")
- 15mm pedal wrench

3400 Pedal & Axle Wrench

- 15mm pedal wrench
- 14x15mm sockets for crankarm bolts and axle nuts

34B1 Pedal & Axle Wrench

- 15mm pedal wrench
- 14mm socket for crankarm bolts and axle nuts

33F5 15mm Pedal Wrench

- Helps mount and remove bike pedals.
- For tightening and loosening pedals with a comfortable ergonomic grip.
- 3/8" square hole for use with a torque wrench to prevent damage to parts.

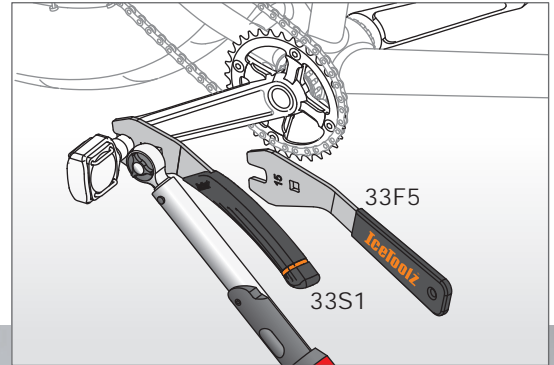

33D1 Dummy Pedal

- Ideal for bike repair and assembly use.
- Easy and efficient mounting and dismounting to rotate the crank.

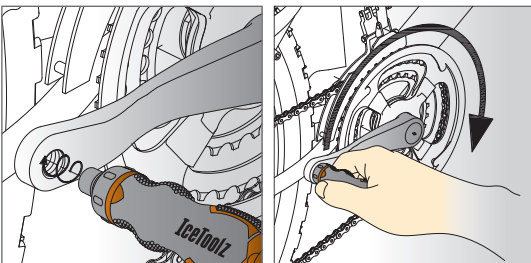

E152

- Pedal Tap, 1/2" x 20TPI (left + right)

E154

- Pedal Tap, 9/16" x 20TPI (left + right)

04C2 Crank Remover

- Interchangeable adaptor fits square and hollow axles.
- Use with 8mm hex key wrench (#35V8).

04D2 Crank Extractor

- Includes 14 x 15mm sockets and 8mm hex key for crank bolt and arm removal.
- Interchangeable adaptor suits both square and hollow axles.

04S1 Crank Tool with Ergonomic Handle

- Equipped with 14 x 15mm sockets and 8mm hex key for crank bolt and arm removal.
- Interchangeable adaptor fits square and hollow axles.

04T1 Crank Arm/Cap Installation Tool

- For Shimano® Hollowtech II

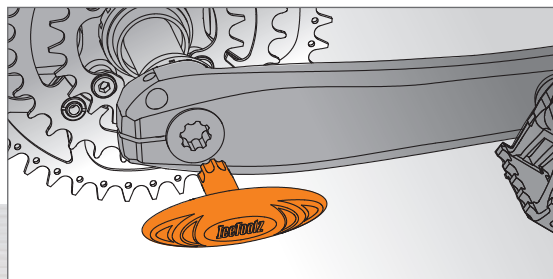

2741 Chaining Lock Ring Tool

- For Shimano® FC-M91xx/ FC-M81xx/ FC-M71xx series



27P5 Chainwheel Nut Tool

- Double-ended design for most slotted-type chainwheel nuts, and crank dust caps
- Securely holds the slotted nut to prevent springing



M582 Shimano® & FSA Chainring Mounting Tool

- Compatible for Shimano® DU-EP800/ E8000/ E7000/ E6100/ E5000 and FSA Spider
- Use with 1/2" Two-way Ratchet Wrench (#43R4x)

M583 Shimano® & FSA Chainring Mounting Tool

- Compatible for Shimano® SM-CRE60 (STePs)
- Use with 1/2" Two-way Ratchet Wrench (#43R4x)

M585 Shimano® & FSA Chainring Mounting Tool

- Compatible for Shimano® DU-EP5/ EP6/ EP801
- Use with 1/2" Two-way Ratchet Wrench (#43R4x)

M801 BOSCH® Lockring Tool

- Compatible for Bosch® Active / Performance Line till 2019
- Use with 1/2" Two-way Ratchet Wrench (#43R4x)

M803 Lockring Tool for Bosch® Gen3/4, YAMAHA® PW-X

- Compatible for Bosch® Gen. 3 and 4 and Yamaha® PW-X drives
- Use with 1/2" Two-way Ratchet Wrench (#43R4x)



Innovation Award



E521 Stripped Pedal Threads Repair Kit

- Ideal for repairing and restoring damaged threads on high-end crank arms.
- Includes one set of tap and five helicoil threads (9/16" x 20TPI) for right and left crank arms.
- Ergonomic handle for use with the tap to enlarge stripped pedal threads.
- Comfortable rubber-grip handle for installing helicoil threads.
- Includes one cleaning brush.
- Includes one bottle of #C143 cutting fluid (2oz / 60ml).



E521H 9/16" Helicoil Threads

- Set of 5 pairs
- Use with the #E521 Stripped Pedal Threads Repair Kit only



E521T Thread Tap Set for #E521

- For enlarging stripped pedal threads on damaged crank arms.
- Use with the #E521 Stripped Pedal Threads Repair Kit only.



11F3 ▶
This tool is compatible only with the original flat-face cup design.

11T1 Bottom Bracket Tool Retaining Kit

- For 1/2-inch drive bottom bracket tools (excludes non-hollow bottom brackets).
- Spring-based tension system ensures secure engagement and prevents slippage.

B.B. Tools List

Parts Specifications	Parts Number for Reference	SHIMANO® TL	IceToolz	Driver
Campagnolo® splined 12-Tooth Adjustable BB cup pegs/pins tool			09B3	1/2" Driver
			11A0	
Cartridge / OCTALINK®	BB-5500, 6500 & ES25 BB-UN26	TL-UN74-S	11B1	1/2" Driver
			11B3	32mm wrench
8-Notch 44mm O.D. cups		TL-UN96	11D3	32mm wrench
BB and headset locking tool			11H1	
22/ 24/ 28.99/ 30mm I.D. bearings	Press-Fit system		11R4	
3-Notch 46mm O.D. locking			M083	1/2" Driver
16-Notch 44mm O.D. cups	Shimano® SM-BB4600, BB51, BB52, BB5700, BB-RS500, BB6700, BB70, BB7900 & BB80 Campagnolo®, Chris King® SRAM®/Truvativ® GXP, FSA MegaExo® Hope®, Race Face® X-type, Surly® Wheels Manufacturing™, Fulcrum® Bafang® BBSH, BBS02 mid-drive e-bike motor lockrings.	TL-FC32/33/36	11C1	
			11F3	8mm hex key
			M091	1/2" Driver
16-Notch 41mm O.D. cups	Shimano® Ultegra® BBR60, Deore XT® MT-800	TL-FC25/37	11C3	1/2" Driver
16-Notch 39mm O.D. cups	Shimano® XTR® BB93 Shimano® Dura-Ace® BB9000	TL-FC24/34	11C5	
12-Notch 46mm O.D. cups	SRAM® DUB™, Race Face® Cinch™ Rotor® BSA30, Zipp® Vuma™ Hawk Racing™ BB3086™		11C7	
			M097	1/2" Driver
12-Notch 50.4mm O.D. cups	BBInfinite® T47 Chris King® ThreadFit™ T47 & ThreadFit™ 30 Enduro® BBright® TorqTite®, Hambini T47 Rotor® T47 External 30 mm & BBright®, BB30, BB386EVO, and PF30 thread-together		M098	1/2" Driver
16-Notch 52.2mm O.D. cups	FSA® MegaEvo® Wheels Manufacturing™ T47 & PF30		M099	1/2" Driver
12-Notch 48 ~ 50mm O.D. cups	Praxis Works® M30		M030	1/2" Driver
16-Notch 53mm O.D. cups	Colnago Threadfit 82.5		M045	1/2" Driver



E355 Derailleur Hanger Alignment Tool

- For rim size 18" ~ 30"



E326 The Wat Seat Tube Gauge

- Takes the hassle out of finding the right seat post
- Measures from Ø25.0 ~ Ø31.8mm



E175 BB Tapping & Facing Tool, English

- For English threading (1.37" x 24TPI).
- Performs facing and tapping.

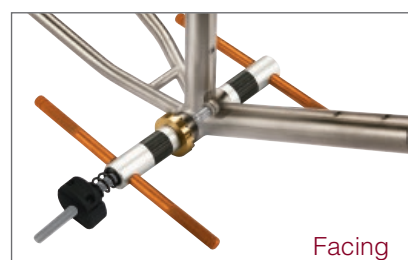

Facing



E181 Head Tube Reaming & Facing Tool

- For 1" and 1-1/8" conventional headset systems.
- Includes #E181A, #E181B, and #E181F components.



Tapping



E185 BB Tapping & Head Tube Reaming & Facing Set

- For 1" and 1-1/8" conventional headset systems
- Kit includes: #E171F, #E171L, #E171R, #E171T, #E173L, #E173R, #E173T, #E181A, and #E181B
- Please refer to the next page for other cutters



Please refer to the next page for other cutters



E282 Thru-Axle Dropout Tap Set

- Restores damaged internal thru-axle threads in the dropout
- Multiple thread formats to support most thru-axle standards on the market
- M12x1.0P, M12x1.5P, M12x1.75P, M15x1.0P, and M15x1.5P
- Manufactured from high-speed steel (HSS) for durability
- Handle not included



E283 Thru-Axle Die Set

- Restores damaged external thru-axle threads
- Multiple thread format to support most thru-axle in the market
- M12x1.0P, M12x1.5P, M12x1.75P, M15x1.0P, and M15x1.5P
- High Speed Steel (HSS) for durability





E173D	T47 Bottom Bracket Tap Set	T47 (M47 x 1.0P). Includes the drive side (Golden) and non-drive side (Black).
E173R	Tap	English (1.37" x 24TPI), for right side, Golden
E173L	Tap	English (1.37" x 24TPI), for left side, Black
E173T	Tap	Italian (1.37" x 24TPI), Green
E171N	Bottom Bracket Reaming & Facing Cutter	Ø41mm for BB86/ 92, PF24, PF41. H.S.S.
E171M	Bottom Bracket Reaming & Facing Cutter	Ø46mm for PF30. H.S.S.
E171R	BB Screw	English (1.37" x 24TPI), for right side, Golden
E171L	BB Screw	English (1.37" x 24TPI), for left side, Black
E171T	BB Screw	Italian (1.37" x 24TPI), Silver
E181L	Centering Cone	For Head Tube inner Ø48 ~ 54mm. Usually used in conjunction with E181S
E181F	Head Tube Facer	Up to Ø45mm
E171F	BB & Head Tube Facer	Up to Ø55mm
E181C	Head Tube Reamer	Ø34mm for 1-1/8" conventional headset systems. Chris King®
E181G	Head Tube Reaming & Facing Cutter	Ø41.4mm for Cane Creek®. 1-1/8" ZS compatible low profile headset systems. H.S.S.
E181S	Head Tube Reaming & Facing Cutter	Ø49.6mm for 1-1/2" OnePointFive headset systems. H.S.S.
E181T	Head Tube Reaming & Facing Cutter	For Campagnolo® Hiddenset compatible integrated headset systems, top. H.S.S.
E181U	Head Tube Reaming & Facing Cutter	For Campagnolo® Hiddenset compatible integrated headset systems, bottom. H.S.S.
E181P	Head Tube Reaming & Facing Cutter	For Cane Creek®. 1-1/8" IS compatible integrated headset systems, top. H.S.S.
E181R	Head Tube Reaming & Facing Cutter	For Cane Creek®. 1-1/8" IS compatible integrated headset systems, bottom. H.S.S.
E181V	Head Tube Reaming & Facing Cutter	For FSA® Integrated #44 series headset systems, 1-1/8", top. H.S.S.
E181W	Head Tube Reaming & Facing Cutter	For FSA® Integrated #44 series headset systems, 1-1/4", bottom. H.S.S.

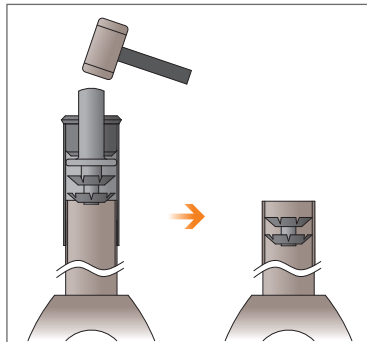

E114 Star Nut Installation Tool

- For 1", 1-1/8", and 1-1/2" fork steerer

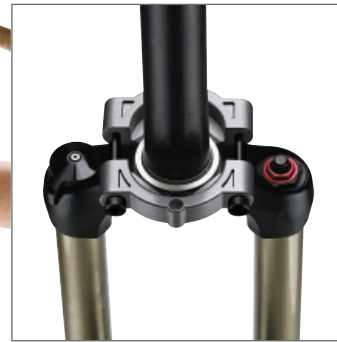

E253 Crown Race Remover

- Up to 1-1/2"

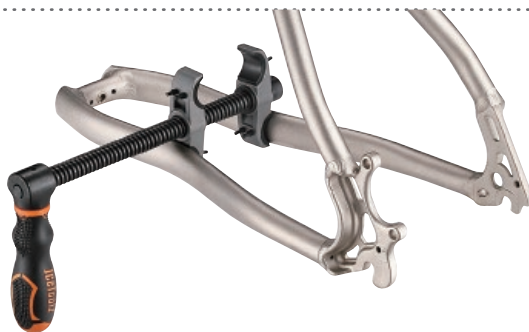

E263 Frame & Fork Adjuster

- Designed for expanding and compressing steel forks, chain stays, and seat stays.
- Trapezoidal thread provides extra power and extends tool life.
- Features protective rubber where the tool contacts the bike.

E263S Spare Rubber Pads for #E263

- Set of 4 pieces



E272 Shuriken Disc Mount Sanding Tool

- Sands the paint flat on disc mount surfaces for precise mounting.
- Patented.



E291 Bearing Puller

- For BB30, BB86, BB92, and Campagnolo® Ultra-torque
- For bearing cup of outer Ø40mm ~ 45mm

E291S Spare Claws for #E291

- Set of 2 pieces

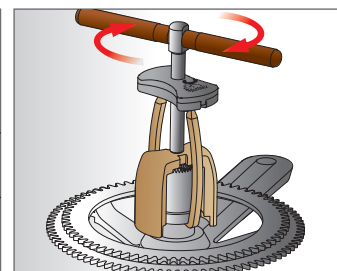
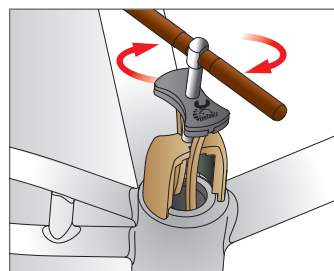

E221 Headset Cups Remover

- For 1" and 1-1/8"

E223 Headset Cups Remover

- For 1-1/4" and 1-1/2"



E293 Press-fit Bearing Removal Tool

- For internal diameter Ø24mm ~ 30mm bottom bracket bearings



E294 Press-fit Bearing Removal Tool

- For internal diameter Ø35mm ~ 46mm bottom bracket bearings





01A1 Cable Pliers

- Thumb lock secures cables for one-handed operation.
- Soft-coated handle ensures comfortable grip.
- Ideal for shop, home, or professional use.

67R2

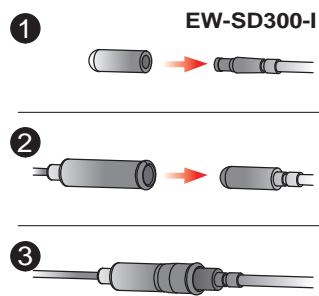

67R2 Adapter for Di2 EW-SD300-I Wire, for Use with #67R1

67R3



67R3 Internal Routing Tool

- Easy installation for cables, wires, and Di2 inside bike frames.
- Plastic-coated stainless steel wire (250mm) with a magnet at the end.
- Suitable for carbon fiber, titanium, and aluminum frames.
- Opposite polarity magnet to seek or attach inside frames.
- Suitable for holes larger than 6mm.
- Also for Di2 EW-SD50-I & EW-SD300-I wires.



67A5 Pro Shop Cable & Spoke Cutter

- For Shimano® SIS SP
- Contains inner wire (Max. Ø3.5mm) and outer casing (Max. Ø7.0mm) reconditioner

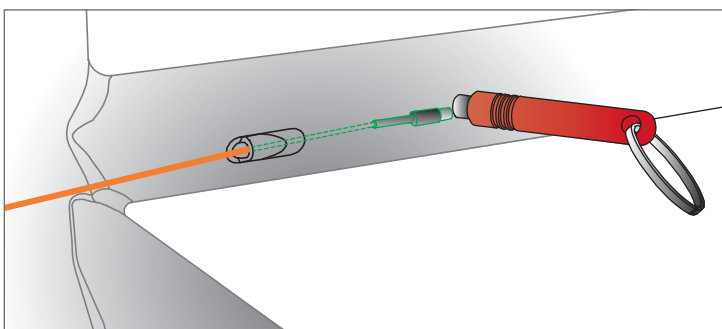

67B4 Cable & Spoke Cutter

- For Shimano® SIS SP



54R4 Bleed Kit, Version 3

- Universal design for all hydraulic disc brake systems
- Compatible with SRAM®, FORMULA®, HAYES®, MAGURA®, and SHIMANO®
- Suitable to use with Mineral and DOT fluid
- With one pair of NBR Gloves (#17G3)
- M5 to M7 adapter for SHIMANO® 105, ULTEGRA or DURA-ACE systems
- New syringes with adapter to fix on the syringe & PU tubes tightly
- With a releasable cable tie which can fix the PU tubes onto the calipers
- With two pieces tubing clips to on/off the flow of syringes

54R5 Bleed Kit, Version 3 with SRAM Bleeding Edge Adapter (54R3J).

54A1 Hydraulic Hose Cutter

- Flawlessly cuts hoses and prevents inner tube deformation.
- Contains one spare blade (#54A1S).



54A1S
Spare Blade for #54A1

54B1 Disc Brake Piston and Pad Alignment Tool

- Reposition pistons
- With ergonomically designed handle for comfortable grip
- Easy to use

54P5 Lipstick Needle Driver

- Designed for inserting hydraulic needle joints into hoses with perfect alignment.
- Prevents damage when inserting soft brass fittings into hydraulic cables.
- Handy for installing or repairing bike brake and hydraulic hose systems.

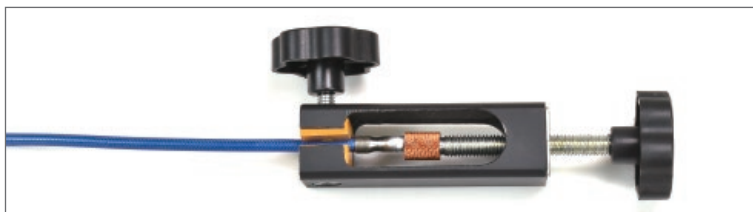

54R3G Adapter for M5x1.0P to M7x0.75P



54R3H Adapter with PU Hose for #54R3, #54R4, #54R5

- ID: ø4mm
- Luer taper



54R3J Adapter for SRAM Bleeding Edge

- For use with #54R4



54R3K Bleed Kit for SRAM Bleeding Edge Set



54R3M Bleed Kit for Shimano® Break System



54R3S Syringes for #54R3, #54R4, #54R5

- 30ml
- Luer taper



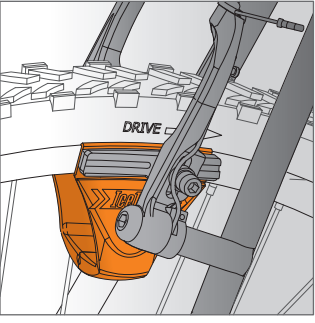

55B1 Croco Brake Shoe Tuner

- Aligns rim brake pads easily and quickly.
- Adjustable for rim widths 15mm ~ 40mm and a max depth of 60mm.
- Patented.



54RA Pneumatic Vacuum Brake Bleeder

- Quick Coupling C Type & ARO210 Type

54RB Pneumatic Vacuum Brake Bleeder

- Quick Coupling C Type & ISO 6150 B Type

54RC Pneumatic Vacuum Brake Bleeder

- Quick Coupling C Type

54RE Pneumatic Vacuum Brake Bleeder

- Quick Coupling C Type & Euro Type



M082 SHIMANO® Disc Brake Lockring Tool

- Compatible for SHIMANO® Disc Brake Lockring - Externally serrated type
- Deepness: 34mm, for both QR-type and Nut-type hubs
- Use with 1/2" Torque Wrench (#E211 / #E214)



54H1 8 x 9mm Hose Wrench

- Maintains the disc brake



54T1 Brake Fluid Tester

- Test the brake fluid quality quickly to check whether it's qualified



55A3 Disc Rotor Truing Tool

- Adjust disc up to 45mm / 1.75"



55B3 Disc Brake Caliper Alignment Tool

- Simple and easy alignment of disc brakes.
- Made from SUS304 stainless steel.

62B3



62B7



62M1



61M1



29M1



29M2



62B3 Pro Shop Chain Tool for Single Speed

- For 1/2" x 3/32", 1/2" x 1/8" BMX chains, including YBN® "Offset Link" chains.
- Thumb-lid isolates fingers from greasy chains while positioning the chain correctly.
- Includes connecting rivet pilot pin breaker.

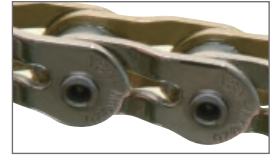

Offset Link Chain

62B7 Pro Shop Chain Tool for Electric Bike Chains

- For 1/2" x 3/16" chains.
- Thumb-lid isolates fingers from greasy chains while positioning the chain correctly.
- Includes connecting rivet pilot pin breaker.



Connecting Pilot Pin Breaker

62M1 Pro Shop Chain Tool for Shimano® Chains

- Perfect for 5~13-speed chains.
- For Shimano® compatible HG/ UG/ IG chains.
- Thumb-lid isolates fingers from greasy chains while positioning the chain correctly.
- Includes connecting rivet pilot pin breaker.

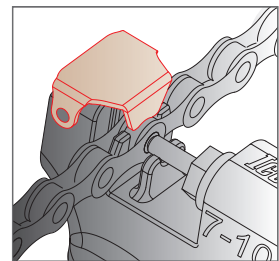

Thumb-lid

61M1 Portable Chain Tool

- Perfect for 5~13-speed chains.
- For Shimano® compatible HG/ UG/ IG chains.
- Thumb-lid isolates fingers from greasy chains while positioning the chain correctly.
- Includes chain hook for installing chains.
- Comes with a chain connectors case.
- Flat design for pocket storage.
- Patented.

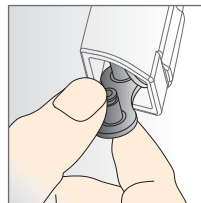

With Chain Connector Case

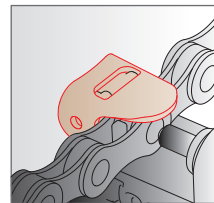

Thumb-lid

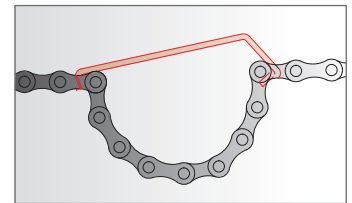

Chain Hook

29M1 Shimano® Compatible Chain Tool

- Perfect for 5~13-speed chains
- For Shimano® compatible HG/ UG/ IG chains

29M2 Shimano® Compatible Chain Tool

- Perfect for 5~13-speed chains
- For Shimano® compatible HG/ UG/ IG chains
- Long handle



29B2S Spare Shaft for #29B2, #29M1



29C2S Spare Shaft for #29C2



61A3S Spare Shaft for #61A3, #61U0



61A4S Spare Shaft for #61A4, #61A5, #61M1



62P3S Spare Shaft for #62xx series

- Spare Shaft for #62B3, #62B7, #62M1, #62P3, #62U3

62D3 Master Link Pliers

- 2-in-1 tool for Master Link assemble and disassemble

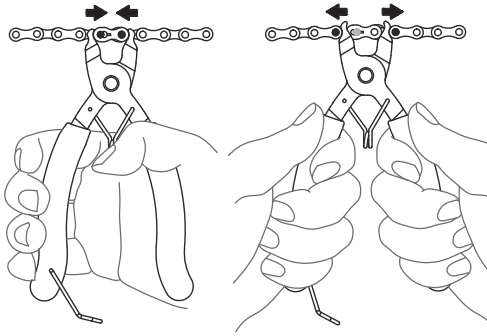

62H1 Foldable Chain Hook

- Hooks chains when installing them.



62C5 Chain Checker

- Accurately checks the wear of the chain
- Uses 3 point system to eliminate roller wear
- Support single-speed, 5~10-speed, and 11~13-speed chains

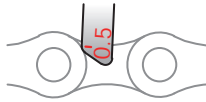

11~13-speed: Servicable
5~10-speed: Servicable
single-speed: Servicable

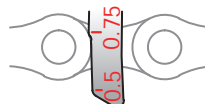

11~13-speed: Replace
5~10-speed: Servicable
single-speed: Servicable

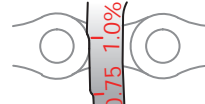

11~13-speed: Replace
5~10-speed: Replace
single-speed: Servicable

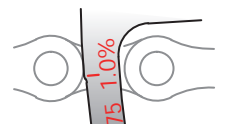

11~13-speed: Replace
5~10-speed: Replace
single-speed: Replace

30C1 ChainMaster

- For rear chain stay, dropout, and derailleur protection during travel.
- Adjustable to fit axle lengths: 130, 135, 160, and 165mm.
- Quick release not included.

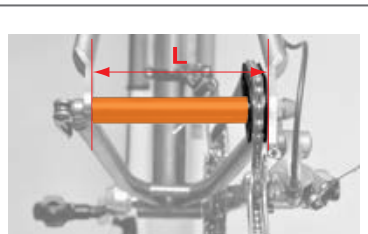

$$L=130\text{mm}=a+d$$

$$L=135\text{mm}=a+b+d$$

$$L=160\text{mm}=a+c+d$$

$$L=165\text{mm}=a+b+c+d$$



Quick release not included.



62D3



62H1



62C5



30C1



0900	Suntour® 2-notch Freewheel Remover	For Suntour® 2-notch freewheel. (23mm spanner)
0903	Suntour® 2-notch Freewheel Remover	For Suntour® 2-notch freewheel. (21mm spanner)
09B3	Freewheel / Cassette Tool	For with Shimano® MF freewheels, Campagnolo® cassettes, and 12-spline bottom bracket cups on square spindle systems (#43R41). Use with a 21mm spanner.
09C1	Cassette Lockring Tool with Guide Pin	For Shimano® CS, SRAM, SunRace, Chris King cassettes and Shimano® Center Lock disc brakes. Guide Pin Ø6mm. (#43R41) or 21mm spanner
09C2	Cassette Lockring Tool with Guide Pin	For Shimano® CS, SRAM, SunRace, Chris King cassettes and Shimano® Center Lock disc brakes. Guide Pin Ø12mm. (#43R41) or 21mm spanner
09C3	Shimano® Cassette Lockring Tool	For Shimano® CS, SRAM, SunRace, Chris King cassettes and Shimano® Center Lock disc brakes. (#43R41) or 21mm spanner
09D1	2-notch Freewheel Remover	For 2-notch freewheels. (24mm spanner)
09E1	4-notch Freewheel Remover	For 4-notch freewheels. (24mm spanner)
09F0	Suntour® 4-notch Freewheel Remover	For Suntour® 4-notch freewheel. (24mm spanner)

#43R41 - 1/2" Two-way ratchet wrench (Page 26)

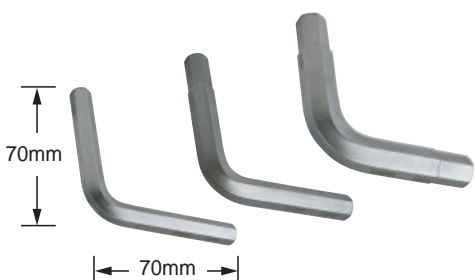

- 37H1** Hub Body Removal Tool
■ 10x10mm
- 37H2** Hub Body Removal Tool
■ 11x12mm
- 37H3** Hub Body Removal Tool
■ 14x15mm

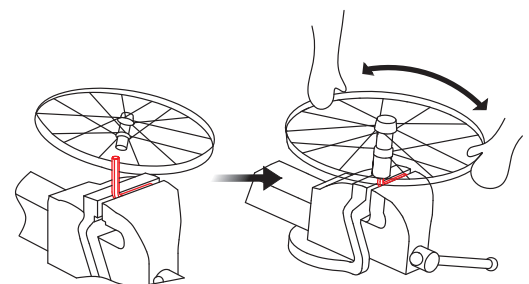



53A2 Freewheel Turner (Chain Whip, 1/2" x 3/32")

- Compatible for multi-speed
- With chain whip 1/2" x 3/32"



53S1 Freewheel Turner (Chain Whip, 1/2" x 1/8")

- Compatible for single-speed
- With chain whip 1/2" x 1/8"
- Ergonomic handle with long anti-slip grip



53S3 Freewheel Turner (Chain Whip, 1/2" x 3/32")



- Compatible for multi-speed
- With chain whip 1/2" x 3/32"
- Ergonomic handle with long anti-slip grip

Cone Wrenches



4713~4719	Cone Wrench	4713~4719: 13/ 14/ 15/ 16/ 17/ 18/ 19mm with 20cm handle
4720~4725		4720~4725: 20/ 21/ 22/ 23/ 24/ 25mm with 23cm handle
47X3	Cone Wrench Set	13+15+17mm, Set of 3 Pieces (#4713 + #4715 + #4717)
47X7	Cone Wrench Set	13+14+15+16+17+18+19mm, Set of 7 Pieces (#4713 + #4714 + #4715 + #4716 + #4717 + #4718 + #4719)
0502	Cone Wrench Set	13x15 + 14x16mm, Set of 2 pieces
37A1	Double-Ended Cone Wrench	13x14mm
37B1	Double-Ended Cone Wrench	15x16mm
37C1	Double-Ended Cone Wrench	17x18mm
37X3	Double-Ended Cone Wrench Set	37A1+37B1+37C1 (13x14mm + 15x16mm + 17x18mm). Set of 3 pieces



08P1	Spoke Tool - Black vinyl coated - For 3.20mm/ 80 ga./ 0.127" nipples	
08C5	Stainless Steel Spoke Tool - For 3.45mm/ 80 ga./ 0.136" nipples	
12B8	Spoke Tool - For 3.2mm (Square) nipples. Use T-handle for high torque tightening.	
12C6	Spoke Tool - For 5.5mm (Hex) nipples. Use T-handle for high torque tightening.	
12D6	Spoke Tool - For 3.6mm (Square) nipples. Use T-handle for high torque tightening.	
12H4	Spoke Tool - For Mavic® wheel systems	



12S4 Nipple Wrench for Deep Rims

- The V-spring holds the nipple to screw onto deep rims, preventing it from dropping.
- With control function to release the nipple after 3 ~ 4mm on the spoke.
- Can also be used with a 1/4" electric screwdriver.



Set of 2 pieces

12S4S Spare V-spring for #12S4, #12S5 (Set of 2).



1206 6-groove Spoke Wrench

- For 10 ~ 15 gauge nipples
- For home workshop use

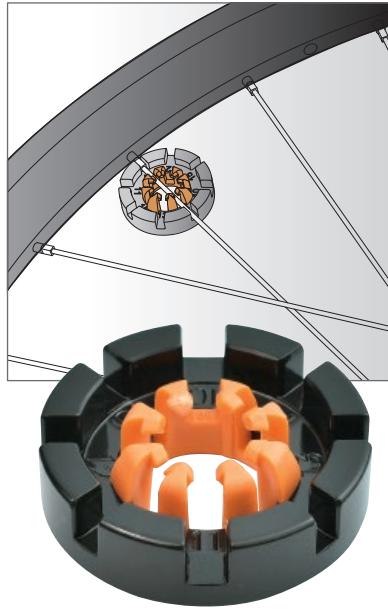

12F8 Forged 8-groove Spoke Wrench

- For 10 ~ 15 gauge nipples
- With spoke holder for more efficient wheel building
- Heat treated for professional grade durability
- Patented



12T4 Bladed Spoke Catcher

- For thickness 0.9 ~ 2.0mm

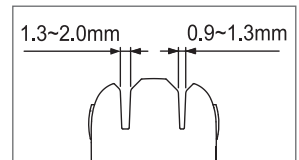

E312 Wheel Centering Gauge

- For rim size 16" ~ 31"



E313 Wheel Centering Gauge with Meter

- For rim sizes 16" ~ 31".
- Measures to a 0.1mm tolerance.
- Black tolerance tabs allow quick assignment of acceptable tolerance ranges.



E381 Spoke Tension Meter

- For rim size 18" and up
- With Japanese Mitutoyo® analog meter
- Scales to 0.01mm





E127T Through-Axle Adaptor

- Use with #E127, #E128, #E129 Truing Stand
- Conical design to be used for shaft diameter 11mm ~ 20mm
- Suitable for hub widths 100 ~ 150mm



E129W Washer For #E129, #E129T and #E129V

- Use with a combination of a 100mm front hub and an outer rim larger than 32mm.



E129 Truing Stand

- Single-arm design, fits 18" ~ 29" rims.
- Heavy base design increases stability.



E129T #E129 Truing Stand with #E127T Through-Axle Adaptor

- For 100mm front hub
- Outer rim up to 32mm
- Includes E127T kit for thru-axle hubs.



E129V #E129 Truing Stand with Dial Gauge and Thru-Axle Adaptor



64P3 POM Tire Levers

- Set of 3 pieces.
- Unique V-shaped design can be fixed easily on spokes.
- Air vent function added on the back.
- Smart V-shaped design acts as a fulcrum on the rim for tire removal.
- Patented.



1903 Steel Tire Lever Set

- Zinc plated
- Set of 3 pieces



64D3 Downhill Tire Lever

- Works for most stubborn bicycle tires.
- Metal parts covered with durable nylon for extra protection on aluminum and carbon fiber rims.



64H2 Heavy Duty Steel Tire Lever

- Forged, zinc plated
- 200mmL

64X1 X-Type Tire Pliers

- A convenient tool for easily installing tires onto rims.
- Ideal for tight tire and rim fits.
- Suitable for tires up to 45mm (1.7") wide.
- Compatible with both mountain and road bikes.
- Nylon material prevents damage to rims or tires.

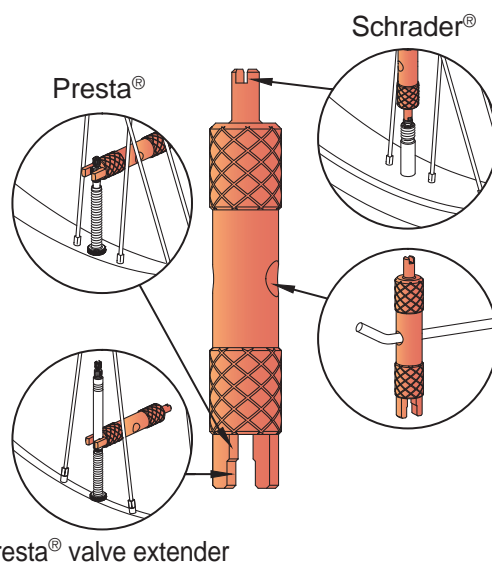

Presta® valve extender

66V1 Valve Core Tool

- For Presta®, Schrader® and Presta valve® extender

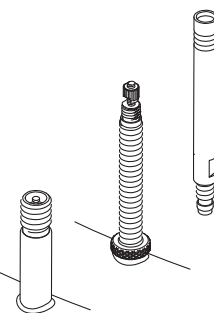



65A1 Tire Puncture Repair Kit

- 18 patches
- 3 tire levers
- 10ml adhesive
- 8cm valve hose
- A sandpaper
- Supplied in a tin box



65B1 Tire Puncture Repair Refill Kit for Work Shop

- 125ml adhesive with brush
- 3 sandpapers (85 x 45mm)
- 30 patches (Ø42mm)



65C1 Puncture Repair Kit for Tubeless Tire

- Plug fork tool
- Patch Strip x 5



56P6 Glueless Patch Set AirDam

- Six patches per set



56J5 Glueless Patch Set AirDam

- 50 sets 56P6 in jar



66G1 10ml Adhesive

- 50 tubes in jar



66F1 Tire Sealant

- For all inflatable rubber tubes and tubeless tires
- Contains 120ml and one small piece of valve tool for Schrader and Dunlop valves
- Applicable for tire pressure under 60 PSI
- Suggest replenishing after half year
- One bottle fills 2 tires



56H1 Glueless Patch Set AirDam

- 10 sets #56E6 per card

56H2 Glueless Patch Set AirDam

- 20 sets #56E6 per card



56E6 Glueless Patch Set AirDam

- Six patches per set



66L1 Bead Lubricant

- Bead lubricant for tubeless tires (100ml).
- Speeds up tire mounting by sliding tires into rims.
- Dries automatically, no cleanup needed.
- Water-based solution prevents damage to tires.

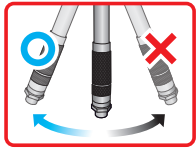

E211 One-way Torque Wrench

- Operating Range: 21 ~ 105N·m.
- For 3/8" & 1/2" drive sockets
- Supplied in a case

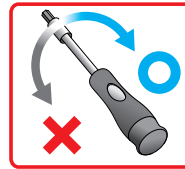

E213 One-way Torque Screwdriver

- Operating Range: 1 ~ 5N·m
- Contains bits of Hex, Pozi®, Phillip, Slot, Torx® (totally 32 bits)
- Contains a 1/4" adaptor
- For 1/4" drive sockets
- Supplied in a case

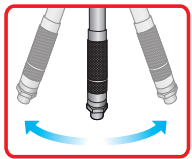

E214 Two-way Torque Wrench

- Operating Range: 20 ~ 100N·m
- For 3/8" & 1/2" drive sockets
- Supplied in a case

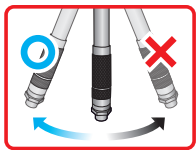

E215 One-way Torque Wrench

- Operating Range: 2 ~ 24N·m
- For 1/4" drive sockets
- Supplied in a case

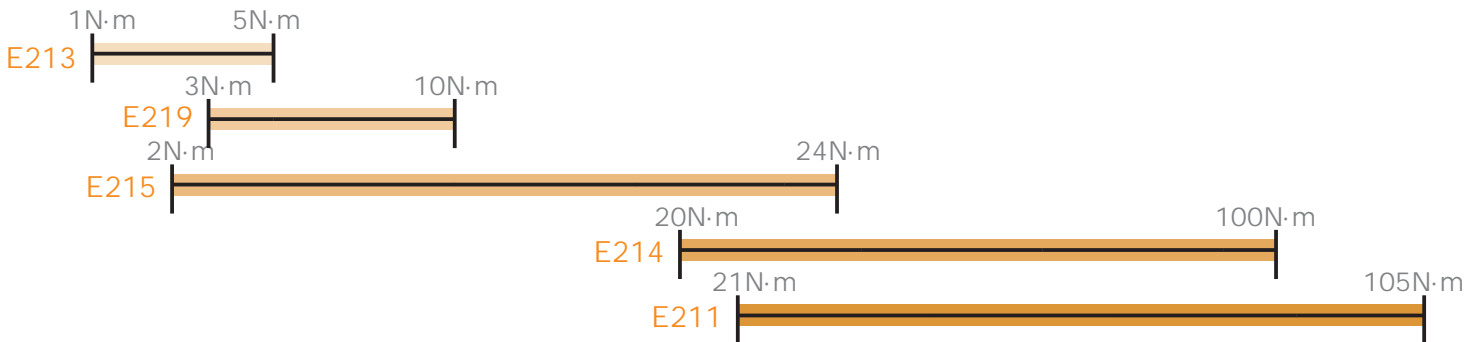

Innovation Award

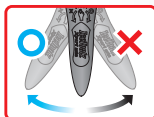

E219 Ocarina Torque Wrench Set

- Operating Range: 3 ~ 10N·m.
- Lightweight and smart design, ideal for mechanics and riders.
- Easily tightens to the correct torque without setting up torque levels.
- Ergonomic handle holds 3/4/5/6mm hex keys and T-25 in one tool.
- Contents: 3/ 4/ 5/ 6mm hex keys and T-25.





16A5 H.S.S. Blade Tube Cutter

- For Ti/ AL/ Cr-Mo/ Steel tubes.
- Not recommended for carbon fiber or threaded tubes (Use #16G1 with a saw).
- For tubes up to 1-5/8" (42mm) diameter.



16A2S Spare H.S.S. Blade

- For #16A2, #16A4, & #16A5 tube cutters



16B1 Tube-End Chamfering Tool

- For easy deburring of sawed-off tubes.
- Suitable for all bicycle tube diameters.
- Deburrs both inside and outside diameters.

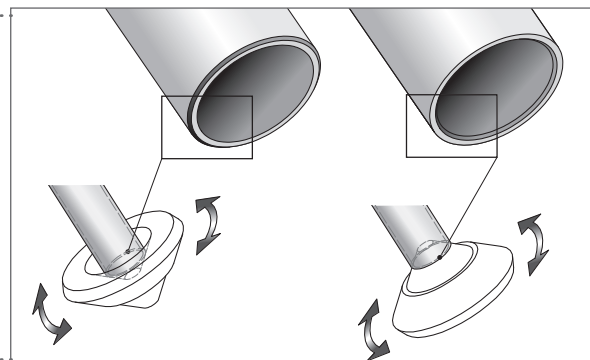

16G1 Saw Guide

- 90-degree no-swing design.
- For tubes up to 1-1/4" (32mm).
- Patented.

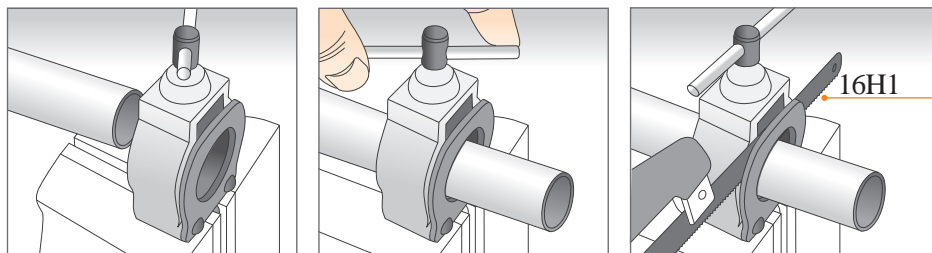

17N1 Rubber Mallet

- When a little force is needed.
- Anti-recoil hammer with beads.
- Coated to prevent marring and marking.
- 2.5 lb/ 1.13 kg.

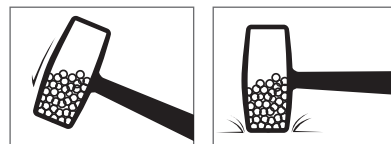



25H6 6" Adjustable Forged Wrench

- With scales to 1mm



28C2 7" Combination Pliers

- 2-tone handle for comfort grip
- Heat treated CR-V for longer lifespan
- Compact 180mm
- Self-opening jaw



28P0 #0 Crosshead (Phillips) Screwdriver with Magnetic Tip

- Ergonomically designed handle for comfortable grip
- 100mm length

28P1 #1 Crosshead (Phillips) Screwdriver with Magnetic Tip

- Ergonomically designed handle for comfortable grip
- 100mm length



28S6 6mm Flat Blade Screwdriver with Magnetic Tip

- Ergonomically designed handle for comfortable grip
- 100mm length



28A4 Remover for O-rings, Oil Seals, and Seal Pullers

- 6-inch length hooks and picks: straight pick, 45-degree hook, 90-degree hook, full hook.
- 3mm metal diameter for working in tight spaces with ease.
- Protects internal components and allows for easy removal without causing damage.
- Knurled anti-slip design provides stable and secure handling.

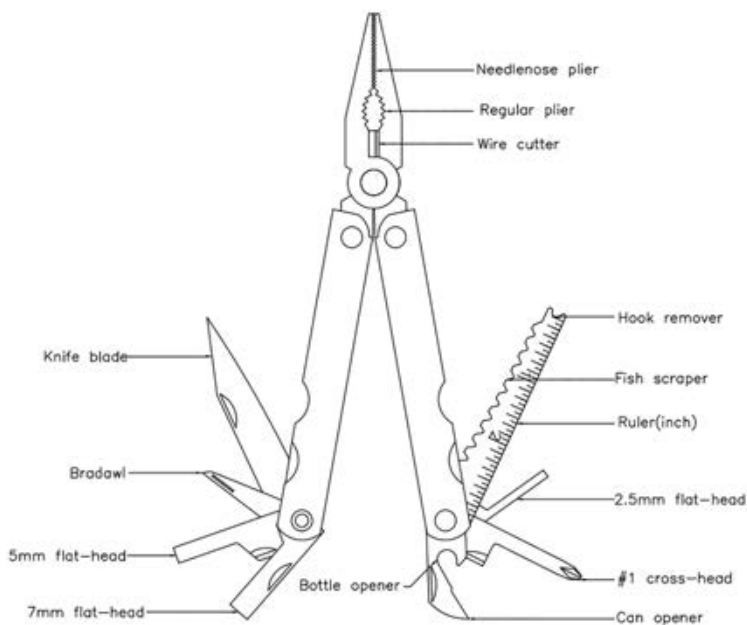

40B1 LifeGuard 15-Function Multi-Pliers

- The foldable multi tool contains pliers, needlenose pliers, wire cutter, blade knives, three slotted screwdrivers, bradawl, bottle opener, can opener, Phillips screwdriver, fish scaler, hook remover, carpenters saw and meters
- Stainless Steel

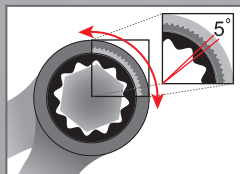

4108-4115 Combination Ratchet Wrench

- 8mm (#4108) ~ 15mm (#4115), 5-degree ratcheting

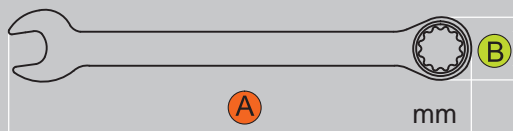

	4108	4109	4110	4111	4112	4113	4114	4115
A	135	158	158	165	166	176	189	196
B	17.85	20.8	20.85	23.3	23.65	25.6	27.95	29.05



41B8 8~15mm Combination Ratchet Wrench Set

- Includes storage pouch with two holes for hanging.
- Contains 8pcs Combination Ratchet Wrenches, 8mm (#4108) ~ 15mm (#4115).



43L41 Basic 1/2" Drive wrench

- 8mm hex key wrench with 1/2" drive adapter
- 196±5mm/ 7.71" handle



43R43 1/2" Two-way Ratchet Wrench

- With quick release function
- 250±5mm/ 9.84" handle



60A2 8x9x10mm Y Box Wrench

- With comfortable Kraton grip, Red

60D2 12x13x14mm Y Box Wrench

- With comfortable Kraton grip, Black



43R41 1/2" Two-way Ratchet Wrench

- With quick release function
- Extra long 395±5mm/ 14.5" handle provides a higher force



E122 Axle Vise

- Holds a variety of axles securely.
- Prevents axle rotation during wheel hub adjustments.
- Magnets keep jaws firmly in place.
- Suitable for Ø5/ 9/ 10/ 12/ 14/ 20/ 25/ 30/ 36mm axles.

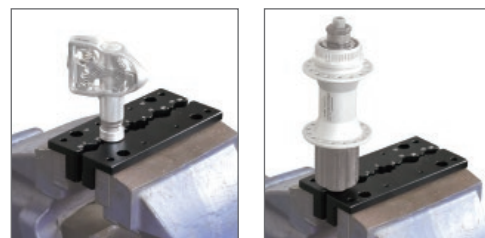

E158 Complete Tap Set with Handle & Storage Pouch

- E166: M3 x 0.5P, dropout alignment screws
- E167: M5 x 0.8P, water bottle, fenders
- E168: M6 x 1.0P, anti-brakes and large fender bracket
- E169: M10 x 1.0P, derailleur hanger
- E152: 1/2" x 20TPI (left + right), pedal taps
- E154: 9/16" x 20TPI (left + right), pedal taps



E295 Bearing Puller Kit

- For the removal of bearings and bushings
- Slide hammer with T-handle
- For internal diameter Ø8mm ~ 32mm bearings



E296 Hub Bearing Installation Kit

- Contacts only the outer ring during installation to prevent damage to the bearing itself.
- Made of 7075 aluminum alloy with CNC machining.
- Treated with anode hard oxidation for durability.

Model	ID x OD	
6000	10 x 26	mm
6001	12 x 28	mm
6900	10 x 22	mm
6901	12 x 24	mm
6902	15 x 28	mm
6903	17 x 30	mm
608	8 x 22	mm
R6	3/8 x 7/8	inch
1526	15 x 26	mm
1728	17 x 28	mm
6800	10 x 19	mm
6801	12 x 21	mm
6802	15 x 24	mm
6803	17 x 26	mm
6804	20 x 32	mm
6805	25 x 37	mm
6806	30 x 42	mm
	24 x 37	mm
	22 x 37	mm

Hex and Star (Torx®) Wrenches



4 5 +

70J2 3-Way with a Screwdriver

- 4 x 5mm hex keys and PH2 screwdriver
- Kraton grip



70A1 3x4x5mm Hex Key

3 4 5



70B1 4x5x6mm Hex Key

4 5 6

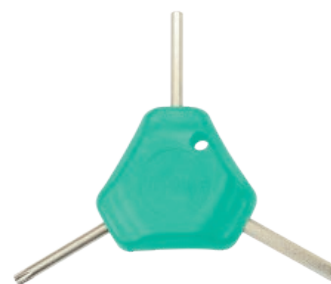

70C1 4x5mm Hex Key + T25

4 5 T25

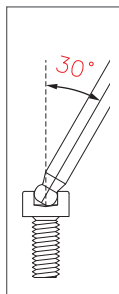

on the wall 1



on the wall 2



7M85 TwinHead Wrench Set

- 2 x 2.5 x 3 x 4 x 5 x 6 x 8mm hex key wrenches (ball-ended).
- T-25 star wrench.
- Ball-ended design allows use at up to a 30-degree angle.
- Exceeds ANSI and DIN standards.
- Includes a stand that can be easily mounted to a bench or wall.

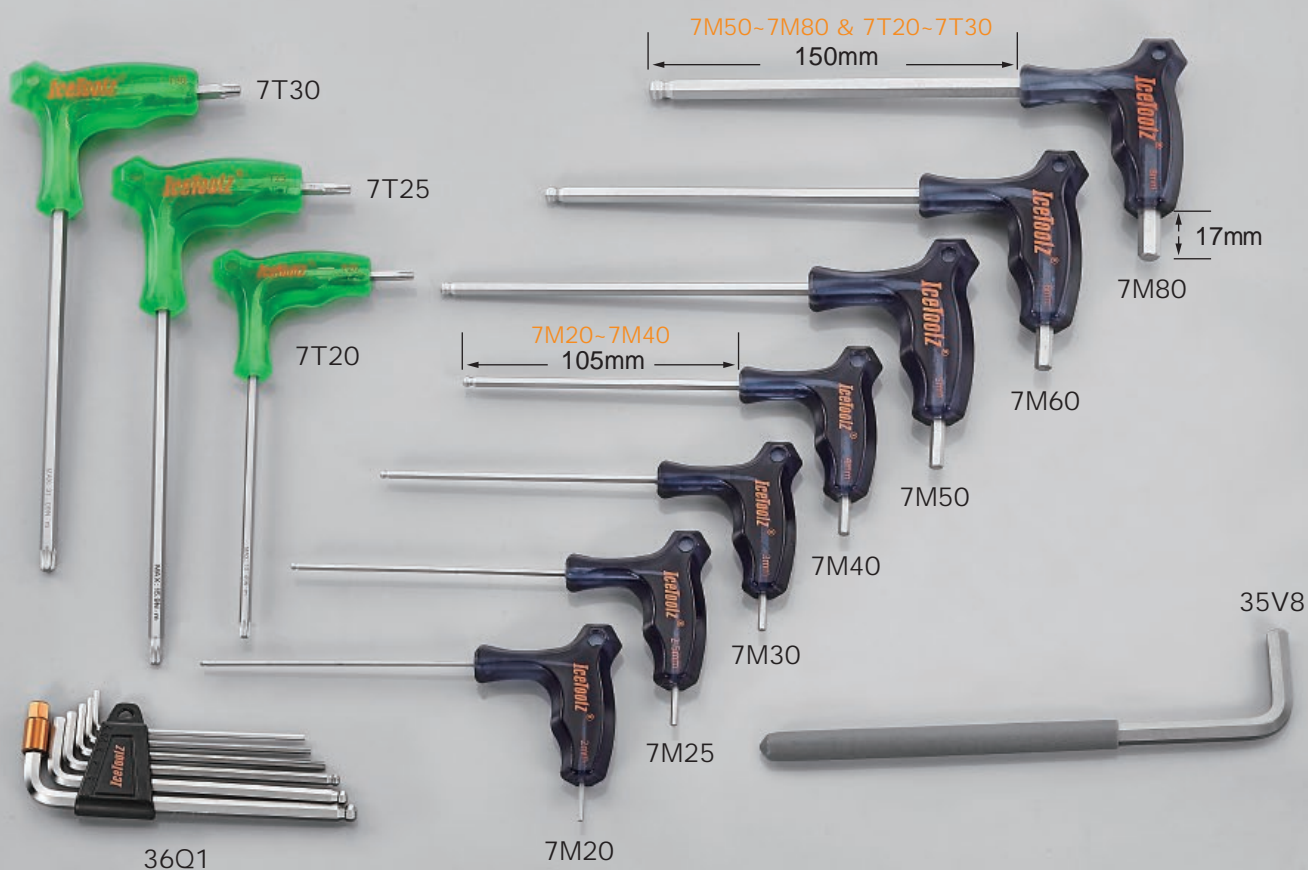

7M20 2mm TwinHead Hex Key Wrench

- 2mm TwinHead hex key wrench with ball-ended

7M25 2.5mm TwinHead Hex Key Wrench

- 2.5mm TwinHead hex key wrench with ball-ended

7M30 3mm TwinHead Hex Key Wrench

- 3mm TwinHead hex key wrench with ball-ended

7M40 4mm TwinHead Hex Key Wrench

- 4mm TwinHead hex key wrench with ball-ended

7M50 5mm TwinHead Hex Key Wrench

- 5mm TwinHead hex key wrench with ball-ended

7M60 6mm TwinHead Hex Key Wrench

- 6mm TwinHead hex key wrench with ball-ended

7M80 8mm TwinHead Hex Key Wrench

- 8mm TwinHead hex key wrench with ball-ended

7T20 T-20 TwinHead Star Wrench

7T25 T-25 TwinHead Star Wrench

7T30 T-30 TwinHead Star Wrench

35V8 8mm Hex Key Wrench

- With gray coating

36Q1 Hex Key Wrench Set

- 2 x 2.5 x 3 x 4 x 5 x 6 x 8mm
- 4 x 5 x 6mm ball-ended



70TA Hex wrench

- 4/ 5/ 6mm hex key

A 91A1 Pocket-17

Hex wrench: 3/ 4/ 5/ 6/ 8mm
T25, PH1, SL5
Spanner: 8/ 9/ 10mm
15mm pedal wrench
Spoke wrench: 0.127"/ 0.130"/ 0.136"
Tire lever/ Bottle opener

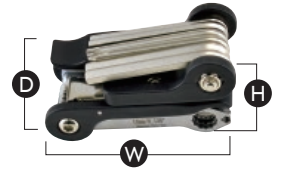

91.4mm x 47.3mm x 44.5mm

W x H x D

B

92A1

Hex wrench:
2/ 2.5/ 3/ 4/ 5/ 6mm
PH1, SL5



96mm x 19mm x 31mm



C

93B1 Release-20

Hex wrench:
2/ 2.5/ 3/ 4/ 5/ 6/ 8mm
PH1, SL5
Spanner:
8/ 9/ 10/ 11/ 12/ 13/ 14/ 15mm
15mm pedal wrench
Spoke wrench: 14G/ 15G
Tire lever



83mm x 28mm x 31mm



D

94H4 Handy-8

Hex wrench:
3/ 4/ 5/ 6/ 8mm
T25, PH1, SL5



71mm x 23.3mm x 33.7mm



E

95A1 Amaze-5

Hex wrench: 4/ 5/ 6mm
PH1, SL5



72.3mm x 23.3mm x 30.7mm



F

95A3 Amaze-10

Hex wrench: 1.5/ 2/ 2.5/
3/ 4/ 5/ 6mm
T25, PH1, SL5



71.2mm x 21.6mm x 37.2mm



G

95A5 Amaze-11

Hex wrench: 1.5/ 2/ 2.5/ 3/
4/ 5/ 6/ 8mm
T25, PH1, SL5



71mm x 21.8mm x 37mm



H

95A7 Amaze-19

Hex wrench: 1.5/ 2/ 2.5/ 3/
4/ 5/ 6/ 8mm



73mm x 24.5mm x 37.2mm



T25, PH1, SL5
Spanner: 8/ 9/ 10/ 15mm
Spoke wrench: 14G/ 15G
Tire lever

I

96B3 Bar-11

Hex wrench:
1.5/ 2/ 2.5/ 3/
4/ 5/ 6/ 8mm
T25, PH1, SL5



88.2mm x 19.5mm x 53mm



J

96T1 Star-8

T9/ T10/ T15/ T20/
T25/ T27/ T30/ T40



87mm x 20.8mm x 38.8mm



K

96K2 Blade Man

Hex wrench: 3/ 4/ 5/ 6mm
PH1, SL5
Knife/ Bottle opener



83mm x 20mm x 34mm

L

97A3

Hex wrench:
1.5/ 2/ 2.5/ 3/ 4/
5/ 6mm
PH1, SL5



80mm x 26mm x 38.3mm

M

97B3

Hex wrench:
1.5/ 2/ 2.5/ 3/ 4/
5/ 6/ 8mm
PH1, SL5

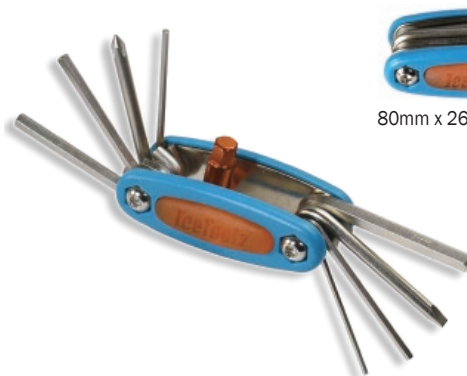

80mm x 26mm x 38.6mm

	A	B	C	D	E	F	G	H	I	J	K	L	M
	91A1	92A1	93B1	94H4	95A1	95A3	95A5	95A7	96B3	96T1	96K2	97A3	97B3
HEX 1.5mm						•	•	•	•			•	•
HEX 2.0mm		•	•			•	•	•	•			•	•
HEX 2.5mm		•	•			•	•	•	•			•	•
HEX 3.0mm	•	•	•	•		•	•	•	•		•	•	•
HEX 4.0mm	•	•	•	•	•	•	•	•	•		•	•	•
HEX 5.0mm	•	•	•	•	•	•	•	•	•		•	•	•
HEX 6.0mm	•	•	•	•	•	•	•	•	•		•	•	•
HEX 8.0mm	•		•	•			•	•	•				•
PH	•	•	•	•	•	•	•	•	•		•	•	•
SL	•	•	•	•	•	•	•	•	•		•	•	•
T9										•			
T10										•			
T15										•			
T20										•			
T25	•			•		•	•	•	•	•			
T27										•			
T30										•			
T40										•			
8mm spanner	•		•					•					
9mm spanner	•		•					•					
10mm spanner	•		•					•			•		
11mm spanner			•										
12mm spanner			•										
13mm spanner			•										
14mm spanner			•										
15mm spanner			•					•					
14G spoke wrench			•					•					
15G spoke wrench			•					•					
15mm pedal wrench	•												
0.127" spoke wrench	•												
0.130" spoke wrench	•												
0.136" spoke wrench	•												
tire lever	•		•					•					
Bottle opener	•										•		
Knife											•		
Weight	226g	132g	176g	118g	118g	142g	150g	156g	156g	120g	148g	146g	154g



A351 VeloClub High Pressure Alu Mini Floor Pump



A451 Sport Steel Floor Pump



A451H Rubber Hose



A551 Comp Steel Floor Pump



A652 Extreme High Pressure Floor Pump



A451V Twin-Valve

■ For Presta®/ Schrader®/ Dunlop®



A653 Cannon Air Compressor

- For Tubeless System
- Up to 160psi
- A new innovative valve that for Schrader®/ Presta®/ Dunlop®

		Material	Valve lock	Length	Air pressure
A351	VeloClub High Pressure Alu Mini Floor Pump	alu	alu thumblock lever	343mm	140 psi 9.6 bar
A451	Sport Steel Floor Pump	steel	twin-valve with thumblock lever	625mm	160 psi 11.0 bar
A551	Comp Steel Floor Pump	steel	twin-valve with thumblock lever	678mm	160 psi 11.0 bar
A652	Extreme High Pressure Floor Pump	alu	alu thumblock lever	658mm	260 psi 18.0 bar
A653	High Pressure Air Tank for Tubeless System	alu	plastic thumblock lever	605mm	160 psi 11.0 bar

A810
CO₂ Inflator & Tubeless
Tire Repair Kit

- Aluminium alloy body
- Supports Schrader and Presta
- Use with threaded cartridge
- With plug fork tool & 2mm Patch Strip x 5



A810F CO₂ Inflator & Tubeless
Tire Repair Kit

- Aluminium alloy body
- Supports Schrader and Presta
- Use with threaded cartridge
- With plug fork tool & 2mm Patch Strip x 5
- Freeze Protector included

A812F
CO₂ Inflator & Tubeless
Tire Repair Kit

- Aluminium alloy body
- Supports Schrader and Presta
- Use with threaded cartridge
- With plug fork tool & 2mm Patch Strip x 5
- Contains 2 cartridges
- Freeze Protector included



A830 CO₂ Inflator

- Aluminium alloy body
- Supports Schrader and Presta
- Use with threaded cartridge



A830F CO₂ Inflator

- Aluminium alloy body
- Supports Schrader and Presta
- Use with threaded cartridge
- Freeze Protector included



A951 Airgun

- Dual Valve Pump Head, 1/4" BSP Inner Wire Type
- Pressure gauge

A952 Airgun

- Dual Valve Pump Head, ID-8mm Hose Barb Type
- Pressure gauge

A95A Airgun

- Dual Valve Pump Head, Quick Coupling ARO 210 Type
- Pressure gauge

A95B Airgun

- Dual Valve Pump Head, Quick Coupling ISO 6150 B Type
- Pressure gauge

A95C Airgun

- Dual Valve Pump Head, Quick Coupling C Type
- Pressure gauge

A95E Airgun

- Dual Valve Pump Head, Quick Coupling Euro Type
- Pressure gauge

	Valve type	Weight	Capacity		
A351	Presta®/ Schrader®/ Dunlop®	260 gram	90 cm ³	Home usage	With gauge
A451	Presta®/ Schrader®/ Dunlop®	1,100 gram	280 cm ³	Home usage	With gauge (2.5")
A551	Presta®/ Schrader®/ Dunlop®	1,280 gram	300 cm ³	Both home/store usage	With gauge (2.5")
A652	Presta®/ Schrader®/ Dunlop®	1,320 gram	300 cm ³	Home usage	With gauge (3")
A653	Presta®/ Schrader®/ Dunlop®	1,760 gram	880cm ³ (at 14.7psi)	Home usage	With safety valve



A911

A912



A91A

A91B



A91C

A91E

A911 Dual Valve Pump Head, 1/4" BSP Inner Wire Type

A912 Dual Valve Pump Head, ID-8mm Hose Barb Type

A91A Dual Valve Pump Head, Quick Coupling ARO 210 Type

A91B Dual Valve Pump Head, Quick Coupling ISO 6150 B Type

A91C Dual Valve Pump Head, Quick Coupling C Type

A91E Dual Valve Pump Head, Quick Coupling Euro Type

Cleaning & Lubrication



C123 Sprocket Cleaning Brush

- Up to 12-speed
- For cleaning the bike chain, cassette, mechs and chain wheels

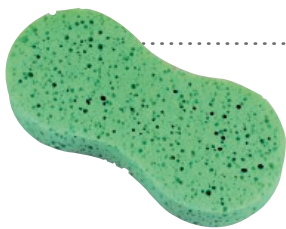

C125 Cleaning Sponge

- Easy to grip and hold without discomfort.
- Highly absorbent.
- Ideal for washing bikes, cars, vans, and household items.
- Dimensions: 235 x 110 x 38mm.



C126 Heavy-Duty Microfiber Brush

- Compresses for flexibility and control.
- Safely and effectively cleans rims.
- Cone-shaped head for easy access to hard-to-reach areas.
- Length: 285mm.



C129 Tube Brush

- Stainless steel bar
- Loop handle
- Ø30mm x 300mmL



C124 Tire Brush Set

- With stiff bristle for aggressive MTB tires & sprockets cleaning
- Set of 2 pieces



C145 / C146 Anti-slip Paste

- For assembling parts made of carbon fiber and aluminum alloy
- Keeps parts from moving or loosening and ensures perfect corrosion protection
- Prevents the two components seizing up
- #C145: 5ml, #C146: 17oz. / 500ml

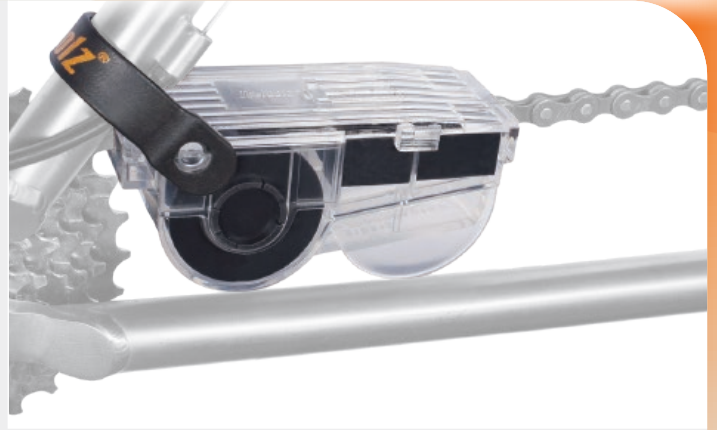
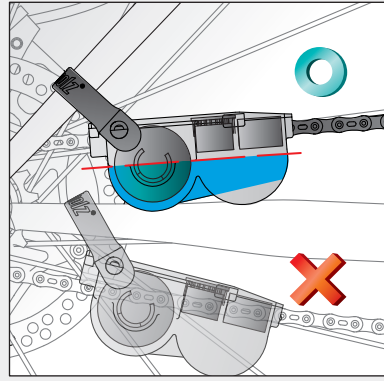

C115 Chain Scrubber

- Features 20 brushes with a 4-sided scrubber system for spotless chain cleaning.
- Integrated rubber band allows hands-free hanging on the seat stay.
- Enhances cleaning efficiency.
- Includes one spare sponge.
- Patented.



C115S Spare Parts for Chain Scrubber

- For chain scrubber #C113 & #C115
- Contains brushes and two sponges

C133



C134



C133 Chain Degreaser

- Environmentally friendly concentrated degreaser.
- New formula ensures quick and effective chain cleaning.
- Excellent degreasing performance.
- Non-corrosive to protect your bike components.
- Recommended for use with the #C115 Chain Scrubber.
- Mix ratio: 1 part degreaser to 3 parts water.
- Volume: 4oz / 120ml.

C134 Jumbo Chain Degreaser

- Environmentally friendly water-based degreaser.
- New formula provides quick and effective chain cleaning.
- Excellent degreasing performance.
- Non-corrosive degreaser to protects bikes and skin.
- Recommended for use with #C115 Chain Scrubber.
- Mix ratio: 1 part degreaser to 3 parts water.
- 15oz / 400ml.



C137

C137 E-Bike Drivetrain Cleaner

- Quickly eliminate built up oil, grease and grime
- 14oz. / 425ml



C141

C141 PTFE Lubricant

- Contains PTFE & other additives to keep your chain running smooth
- 4oz. / 120ml



C143

C143 Cutting Fluid

- For cutting, tapping, facing, and reaming
- Extends the lifespan of the tools
- 2oz. / 60ml



C147

C147 Chain Lubricant (for E-Bike)

- Engineered specially for e-Bike chains to withstand high temperature and maintains viscosity during usage
- High cooling capacity and electric insulator
- 4oz. / 120ml

C161



C162



C161 Dry Lubricant

- Ideal for dry, dusty, gravel, and dirt environments.
- Decreases dust buildup and component wear.
- Maintains high-speed lubrication.
- Not recommended for wet conditions (use #C141).

C162 Dry Lubricant with PTFE

- Ideal for dry, dusty, gravel, and dirt environments.
- PTFE-enhanced formula minimizes dust buildup and component wear.
- Maintains high-speed lubrication.
- Not recommended for wet conditions (use #C141).



C177 E-Bike Grease

- Ideally for the circuit and parts of motors in various electric bike
- Non-conductive
- Protects metal against corrosion, heat, and water
- Highly lubricating even with small amount
- Temperature range: -25°C ~ 200°C
- 5ml



C171 / C172 Anti-Wear Copper Grease

- Protects metal against corrosion, heat, and water
- Ideally for hubs, screws, nuts, bolts, bearings, and BBs
- Highly lubricating even with small amount
- Temperature range: -25°C ~ 200°C
- C171: 17oz / 500ml, C172: 4oz / 120ml



C178 Leak-Control Grease Gun

- Ergonomic design for #C172 Copper Grease

C182



C183



C184



C182 / C183 / C184 Bike Wash

- Environmentally friendly bike wash for effective bike cleaning.
- Excellent degreasing performance.
- Non-corrosive; protects bike components.
- Concentrated formula (#C183 & #C184).
- Mix ratio: 1 part bike wash to 1 part water.
- #C182: 10oz./ 300ml
- #C183: 2pt./ 1000ml
- #C184: 10.5pt./ 5000ml



C189 Bike Cleaning Wipes

- Cleans your bike by breaking down grease, oil, dirt, and more.
- Made with environmentally friendly, non-toxic ingredients.
- Eliminates odors without any pungent smell.
- Towel size: 26 x 30cm.
- 100 sheets.



C191 Disc Brake Cleaner

- Removes brake dust and oil.
- Reduces brake noise.
- Restores braking performance.
- Leaves no residue.
- Free of CFCs.
- 14oz/ 425ml.



C192 Grease Remover

- Bubble-based
- 14oz./ 425ml



C193 Suspension Cleaner

- Cleans dirt adhered to suspension fork stanchions.
- Activates rubber oil seals to extend fork lifespan.
- Keeps dust off while riding to protect friction points.
- 5oz/ 150ml.



C196 Hand Cleaner

- High degreasing power.
- Antibacterial properties.
- Includes protective agents and proteins for gentle care.
- 10.5pt/ 5000ml.



C311 Bike Polisher

- Restores your bike's original shine.
- Forms a thin, protective layer on the bike's surface.
- Non-corrosive, non-toxic, and eco-friendly.
- Suitable for iron, steel, aluminum, titanium, and carbon fiber.
- 14oz/ 425ml.



C312 Frame Protection

- Reduces damage from sunlight or rain
- Suitable for both matte and clear coating
- 10oz./ 300ml

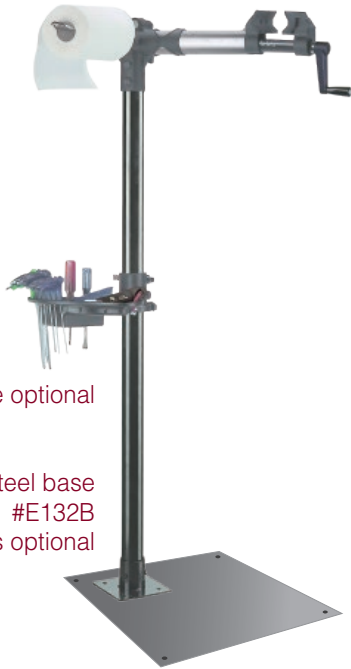

Tools are optional

Steel base
#E132B
is optional



E132 Floor Repair Stand

- Single clamp design.
- Includes tool tray #E132T.
- Optional steel plate (#E132B) available.

E132B Steel Plate

- Steel plate for #E132 Floor Repair Stand
- 600 x 600 x 8mm

E138 Professional Repair Stand

- Rotatable clamping mechanism holds Ø25.4 ~ 55mm tubes.
- Quick-release for easy adjustment.
- Foldable for better mobility.
- Sturdy 3-leg design provides stability and portability.
- Contains paper towel holder.
- Includes a carry bag.
- Tool tray (#E132T) and tools are optional.

E633 SuperLifter-III Repair Stand

- Smaller packaging form factor suitable for parcel delivery
- E-bike compatible up to 60kg
- Rotatable rubber clamp for Ø25.4mm ~ Ø55mm
- Adjustable height from 50cm to 180cm (19.7"~70.8')
- 1 turn on the handle = 10cm in height
- Integrated wheels for better indoor and outdoor maneuver
- Large base to support the bike firmly to the top
- Includes integrated work tray
- Patented



E633 = PART ① + ②



E633S Spare Arm Set for #E139, #E631 & #E633 SuperLifters



E633Q Metal Quick Release Lever for #E631 & #E633 Clamps



E631D Replacement Clamp Parts

- Includes clamps, rubber pads & screws



E631P Replacement Rubber Pads for #E631 & #E633

- Includes clamps, rubber pads & screws



E631W Replacement wire for #E139, #E631 & #E633 SuperLifters

- Includes clamps, rubber pads & screws



E137 Professional Repair Stand

- Rotatable clamping mechanism holds $\varnothing 25.4 \sim 55\text{mm}$ tubes.
- Quick-release for easy adjustment.
- Foldable for better mobility.
- Sturdy 3-leg design provides stability and portability.
- Contains paper towel holder.
- Tool tray (#E132T) and tools are optional.

Tool tray and tools
are optional



E137C Spare Clamp

- For #E132, #E134, #E136, #E137, #E138, #E139 Repair Stands



E137S Spare Arm Set

- For #E132, #E134, #E137, #E138 Repair Stands



E614 Rotatable Race Stand

- 360-degree rotatable for versatile use.
- Ideal for bike servicing, setup, and cleaning.
- Crossbar compatible with all fork and rear dropouts.
- Adjustable to fit various bike types.
- Includes a strap to securely hold the frame for added safety.
- Auto-adjustable foot pads ensure stability on uneven floors.
- Supports up to 25kgs/ 55.12lbs and a height of 90cm/ 3'.
- Includes a carry bag.

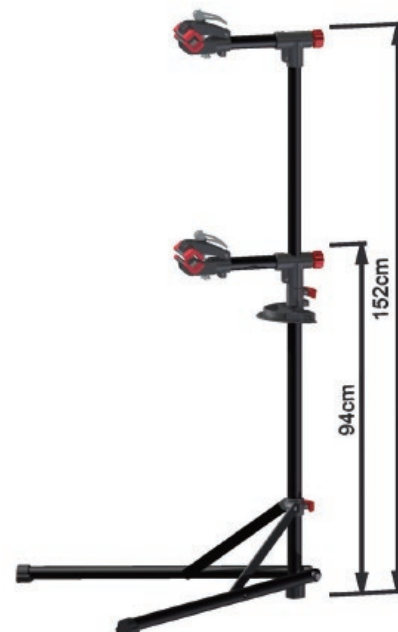
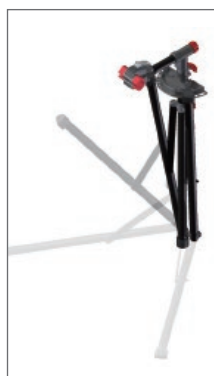

E621 Franky Repair Stand

- Large foot design for a sturdy base.
- Foldable for easy storage and transportation.
- Supports up to 20kgs/ 44lbs and a height of 152cm/ 59.84'.

82F4 Essence Tool Kit



- #04C2: Crank Remover
- #64P3: Tire Lever Set, Set of 3 Pieces
- #25H6: 6" Forged Adjustable Wrench
- #39H4: 9 x 10mm Open-ended Wrench
- #35V8: 8mm Hex Key Wrench
- #29M1: Shimano® Compatible Chain Tool (5 x 6 x 7 x 8 x 9 x 10 x 11 x 12 x 13-speed)
- #D8D4: Connecting Tool (from 8mm changing to 1/2")
- #09C1: Cassette Lockring Tool with Guide Pin
- #36Q1: 2/ 2.5/ 3/ 4/ 5/ 6 Hex Key Wrench, 4 x 5 x 6mm Ball-end
- #28P1: #1 Philips Screwdriver
- #28S6: 6mm Flat Blade Screwdriver
- #34S4: Lockring Tool, Freewheel Turner, and 15mm Pedal Wrench
- #11F3: Shimano® Hollowtech II Compatible BB Tool
- #12F8: 10-15G Forged 8-groove Spoke Tool
- #35T25: T-25 Torx Wrench, 20 x 100mmL
- #11B1: Shimano® / ISIS Drive BB Tool
- Product Dimensions: 30.5 x 21 x 6.5cm
- Weight: 1.8kg
- Color: Black

82F6 CarbonFix Tool Kit



The tool set for maintaining your beloved carbon fiber bicycle

- Effortlessly handles bike adjustments, cleaning, maintenance, and basic repairs.
- Includes a precision 3-10Nm torque wrench to safeguard your bike from damage due to overtightening.
- Chain pliers for a safe chain cleaning with harsh detergents.
- Never lose the adapter with a thoughtfully designed storage space.
- #09C1: Cassette Lockring Tool with Guide Pin
- #34S4: Lockring Tool, Freewheel Turner, and 15mm Pedal Wrench
- #35V8: 8mm Hex Key Wrench
- #36Q1: 2/ 2.5/ 3/ 4/ 5/ 6 Hex Key Wrench, 4 x 5 x 6mm Ball-end
- #62C5: Chain Checker
- #62D3: Master Link pliers
- #64P3: Tire Lever Set, Set of 3 Pieces
- #96T1: T9/ T10/ T15/ T20/ T25/ T27/ T30/ T40 Torx® compatible wrench
- #C145: Anti-slip Paste
- #D8D4: Connecting Tool (from 8mm changing to 1/2")
- #E219: Ocarina Torque Wrench Set
- Weight: 1.5kg
- Color: Silver

82A6 Pronto Tool Kit



- #04C2: Crank Remover
- #0502: 13x15 + 14x16mm Cone Wrench Set, 2 Pieces
- #06H8: 30x32 + 36x40mm headset wrench
- #09C5: Freewheel / Cassette Lockring Tool
- #11B3: Shimano® / ISIS Drive Cartridge BB Tool
- #11F3: Shimano® Hollowtech II Compatible BB Tool
- #11H1: Lockring Tool
- #12F8: 10-15G Forged 8-groove Spoke Tool
- #25H6: 6" Forged Adjustable Wrench
- #29C4: Shimano® Compatible Chain Tool (6 x 7 x 8 x 9-speed)
- #3400: 15mm Pedal Wrench & 14x15mm sockets
- #35T25: T-25 Torx Wrench, 20x100mmL
- #35V8: 8mm Hex Key Wrench
- #36Q1: 2/ 2.5/ 3/ 4/ 5/ 6 Hex Key Wrench, 4 x 5 x 6mm Ball-end
- #39H4: 9 x 10mm Open-ended Wrench
- #53A2: Multi-speed Freewheel Turner (Chain Whip, 1/2" x 3/32")
- #64P3: Tire Lever Set, Set of 3 Pieces
- #P1P2 #1/ #2 Philips Screwdriver
- #S4S6: 4/ 6mm Flat Blade Screwdriver
- Product Dimensions: 30.5 x 21 x 6.5cm
- Weight: 2.65kg
- Color: Silver

85A5 Advanced Mechanic Tool Kit



- Carry Case
- #04C2: Crank Remover
- #09C1: Cassette Lockring Tool with Guide Pin
- #11B1: BB Tool for Shimano® / ISIS Drive Cartridge
- #12F8: 10-15G Forged 8-groove Spoke Tool
- #17M4: Tape Measure, Up to 3M / 10FT
- #25H6: 6" Forged Adjustable Wrench
- #28P1: #1 Philips Screwdriver
- #28S6: 6mm Flat Blade Screwdriver
- #33F5: 15mm Pedal Wrench
- #36Q9: Hex Key Wrench Set w/Ball-ended (1.5 x 2 x 2.5 x 3 x 4 x 5 x 6 x 8 x 10mm)
- #3TA1: Star Key Wrench (T-10 x 15 x 20 x 25 x 27 x 30 x 40 x 45 x 50)
- #43R41: 1/2" Two-way Ratchet Wrench
- #47X7: 13 x 14 x 15 x 16 x 17 x 18 x 19mm Cone Wrench Set
- #53A2: Multi-speed Freewheel Turner (Chain Whip, 1/2" x 3/32")
- #62M1: Pro Shop Chain Tool (for 5 x 6 x 7 x 8 x 9 x 10 x 11 x 12 x 13-speed)
- #64P3: Tire Lever Set, Set of 3 Pieces
- #67B4: Cable Cutter
- #C123: Sprocket Cleaning Brush
- #M091: BB Installation Tool for Shimano® Hollowtech II
- Product Dimensions : 37.8 x 16.8 x 14.5cm
- Weight: 5.4kg
- Color: Black

84S2 Starter Tool-roll



- Keeps your cycling accessories organized and accommodate in the Starter Tool-roll
- The simple, versatile design allows you to stow all sorts of tools
- Durable polyester storage roll
- Simple roll-up design carries essential ride necessities
- Contains :
 - #28S6 : 6mm flat blade screwdriver with magnetic tip
 - #28P1 : #1 Philips screwdriver with magnetic tip
 - #29M1 : Shimano® compatible chain tool (5 x 6 x 7 x 8 x 9 x 10 x 11 x 12 x 13-speed)
 - #36Q1 : 2/ 2.5/ 3/ 4/ 5/ 6 hex key wrench, 4 x 5 x 6mm ball-ended
 - #65A1 : Tire puncture repair kit (18 patches, 3 tire levers, 10ml adhesive, 8cm valve hose, A sandpaper)
 - #C123 : Sprocket cleaning brush (up to 10-speed for aggressive cleaning)

801A Zipper Tool Kit



- #1100: 15mm wrench & locking tool
- #1206: 10-15G Forged 6-groove Spoke Tool
- #25H6: 6" Adjustable Forged Wrench
- #60A2: 8 x 9 x 10mm Y box wrench
- #60D2: 12 x 13 x 14mm Y box wrench
- #64P3: Tire Lever Set, Set of 3 Pieces
- 4 x 5 x 6 x 8mm Hex key
- 4 x 6mm flat blade screwdriver
- #1x#2 Philips screwdriver

83A1 Storage Bottle + Tool Kit



Product includes tire lever x 3, glue, patch x 18



Image contains for reference only

- Keeps your tools and spares secure and protected, in a safe spot when you need them the most
- PE material bottle case, strong and durable for holding tools
- Bottle shaped case, portable and convenient for outdoor use

83A2 Storage Bottle



- Keeps your tools and spares secure and protected, in a safe spot when you need them the most
- PE material bottle case, strong and durable for holding tools
- Bottle shaped case, portable and convenient for outdoor use

85A7 Pro Shop Mechanic Tool Kit



- Carry Case
- #C153: Pro Shop Apron
- #43R41: 1/2" Two-way Ratchet Wrench
- #33S1: 15mm Pedal Wrench
- #53S3: Multi-speed Freewheel Turner (Chain Whip, 1/2" x 3/32")
- #C123: Sprocket Cleaning Brush
- #0502: 13 x 15 + 14 x 16mm Cone Wrench Set, 2 Pieces
- #62M1: Pro Shop Chain Tool (for 5 x 6 x 7 x 8 x 9 x 10 x 11 x 12 x 13-speed)
- #04C2: Crank Remover
- #09C1: Cassette Lockring Tool with Guide Pin
- #12F8: 10-15G Forged 8-groove Spoke Tool
- #56E6: Glueless Patch Set AirDam, 6 Pieces
- #M091: BB Installation Tool for Shimano® Hollowtech II
- #30C1: ChainMaster
- #67B4: Cable Cutter
- #97T1: "Star-8" T-9 x 10 x 15 x 20 x 25 x 27 x 30 x 40 Star Keys
- #97A3: "Mighty-9" 1.5 x 2 x 2.5 x 3 x 4 x 5 x 6mm Hex Keys, +/- Screwdrivers
- #25H6: 6" Forged Adjustable Wrench
- #35V8: 8mm Hex Key Wrench
- #64P3: POM Tyre Levers, Set of 3 Pieces
- #28P1: #1 Philips Screwdriver
- #28S6: 6mm Flat Blade Screwdriver
- #27P5: Chainwheel Nut Tool
- Product Dimensions: 37.8 x 16.8 x 14.5cm
- Weight: 4.9kg
- Color: Black



P413 Event and Display Stand

- Holds up to 10 bikes by the saddle.
- Includes a rubber stripe at the top to protect the saddle rail.
- Quick-release function for easy assembly and disassembly.
- Includes a carry bag and mesh pockets on both sides.
- Maximum Load: 100kg.
- Optional extension kit #P411S.
- Size: 2,760 x 810 x 1,215mm

P411S Event and Display Stand Extension Kit

- For #P412 and #P413
- Extends 4 ~ 6 bikes
- Size: 1,470 x 810 x 1,215mm



P643 Stand-By-Me

- Bike stand for display and repair.
- Adjustable chain stay holder for height and angle to fit various frame sizes and styles.
- Maximum Load: 25kg.



P646 Rear Axle Bike Stand

- Up to 29"
- Maximum Load: 25kg
- Patented



P655 Two-way Storage Hook

- For slat wall or regular wall
- Maximum Load: 20kg
- Patented



P621 Eagle Bicycle Lifter

- Dual pulley system
- Maximum Load: 25kg
- Maximum Height: 3 meters

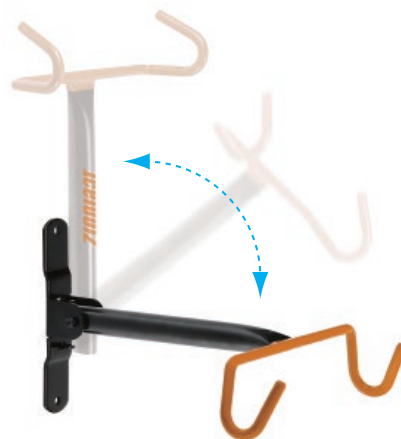

P631 Bull Storage Rack

- Foldable for compact storage.
- Maximum Load: 20kg.



P678 Hook with Roller

- Designed for fatter tires up to 70mm width.
- Maximum Load: 20kg.



P685 Hook with Dowel

- Designed for fatter tires up to 70mm width.
- Maximum Load: 20kg.



P679 Hook with Roller

- Designed for fatter tires up to 70mm width.
- Maximum Load: 20kg.



P686 Storage Hooks - Machine Thread with Nuts and Spring Washers

- Set of 2 pieces
- Black vinyl coated
- Maximum Load: 20kg per hook



P684 Storage Hooks - Wood Thread with Dowels

- Set of 2 pieces
- Black vinyl coated
- Maximum Load: 20kg per hook



P688 Hook with Dowel

- Designed for fatter tires up to 70mm width.
- Maximum Load: 20kg.



F164 Safety Flag, one-piece, length 60", white fiberglass pole

F168 Safety Flag, one-piece, length 60", orange fiberglass pole



F264 Safety Flag, two-piece, length 60", white fiberglass pole

F268 Safety Flag, two-piece, length 60", orange fiberglass pole

F274 Safety Flag, two-piece, length 72", white fiberglass pole



F364 Safety Flag, three-piece, length 60", white fiberglass pole

F374 Safety Flag, three-piece, length 72", white fiberglass pole

Accessories



17G2-17G4-17G6 NBR Gloves

- Keeps your hands clean of oils, acids, and dirt while maintaining a natural feel.
- 100 pcs per box.

- 100 PCS/BOX.
- Powder-Free.
- Protein-Free.
- High Flexibility.
- Textured.
- Non-Sterile.
- Ambidextrous.
- Anti-Oil.
- Acid Resistant.
- Alkali Resistant.

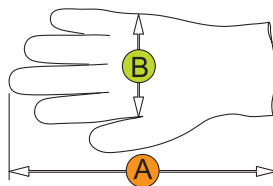

Item	17G2	17G4	17G6
Size	M	L	XL
A	23cm	23cm	23cm
B	9.5cm	10.5cm	11.5cm

± 0.5cm



17D1 Phone Holder Silicone

- Suitable for mounting on handlebars with diameter 22 to 38 mm
- Suitable for phones between 6.0 ~ 9.0 x 12.0 ~ 16.0 cm
- High resistance to environmental influences and UV radiation
- Remains flexible at both high and low temperatures
- Tool-free mounting



C155 Pro Shop Apron

- Double zip center pockets, dual open side pockets, and single zip chest pocket
- Tough enough for a pro shop & comfortable enough for home use



PVC Wall Sign

- Size: 550x193mm



Andorra

Race Company

Tel : +33(0)490.04.46.60
e-mail : contact@racecompany.fr
http://www.racecompany.fr

Argentina

ARIES COMERCIAL S.A.

Tel : +54 11 4788 3370
e-mail : info@aries-comercial.com
http://www.aries-comercial.com/

Australia-1

GPI Apollo Bicycles

Tel : +613 9700-9400
e-mail : sales@apollobikes.com
http://apollobikes.com

Australia-2

KWT Imports

Tel : +617 5445 1991
e-mail : info@kwtimports.com.au
https://www.kwtimports.com.au/

Austria

BBF Bike GmbH

Tel. +49(0)3342. 354 325
e-mail : info@bbf-bike.de
http://www.bbf-bike.de

Belgium

Buzaglo BV

Tel : +31 36.521-0100
e-mail : info@buzaglo.nl
http://www.buzaglo.nl

Brazil

Isapa Importacao e Comercio Ltda.

Tel : +5511.2823-6500
e-mail : bike@isapa.com.br
http://www.isapa.com.br

Bulgaria

Velomania LTD

Tel : +359 2 812 7060
e-mail : info@velomania-bg.com
http://www.velomania-bg.com

Canada-1

Orange Sport Supply, Inc.

Tel : +1 604.990-5110
e-mail : info@orangesportsupply.com
http://www.orangesportsupply.com

Canada-2

D'Amour Bicycle & Sports Inc.

Tel : +1 514-6376511 / +1 800 363-8743
e-mail : info@damourbicycle.com
http://www.damourbicycle.com

Chile

Oxford SpA

Tel : +56.22.2463-2045
e-mail : enzoe@oxford.cl
http://www.OxfordStore.cl

China

上海晨瑞商贸有限公司
Tel : +86 21.3358-0260
e-mail : srchen@live.cn

Columbia

HA Bicicletas S.A.

Tel : +57 4.285-5040
e-mail : servicioalcliente@habicicletas.com
http://www.habicicletas.com

Czech

Profil Bicycles CZ

Tel : +420.7394-73391
e-mail : profil.bicycles@iol.cz
http://www.profil-bicycles.cz

Ecuador

Importadora Comercial Sucre Cia. Ltd.

Tel : +593 2.247-8625
e-mail : ics@uio.satnet.net
http://www.importadorasucre.com

France

Race Company

Tel : +33(0)490.04.46.60
e-mail : contact@racecompany.fr
http://www.racecompany.fr

Germany

BBF Bike GmbH

Tel. +49(0)3342. 354 325
e-mail : info@bbf-bike.de
http://www.bbf-bike.de

Greece

Velomania LTD

Tel : +359 2 812 7060
e-mail : info@velomania-bg.com
http://www.velomania-bg.com

Guatemala

Bicicletas Mercurio S.A. de C.V.

Tel : +52 444-1442-400
e-mail : contacto@windsorsportsgroup.com
http://www.windsorsportsgroup.com

Hungary

Biker Kft

Tel.: +36 1.278-1021
e-mail : biker@biker.hu
http://www.biker.hu

India

Extreme Adventure Sports

Tel : +91 20 6605 0600
e-mail : raman.jpa@gmail.com
www.exadsports.com

Ireland

Solent (UK) Ltd, T/A Windwave

Tel : +44 23.9252-1912
e-mail : sales@windwave.co.uk
http://www.windwave.co.uk

Italy

RMS SPA

Tel : +39 0362.27301
e-mail : info@rms.it
http://www.rms.it

Japan

Rinei Company Ltd. / リンエイ株式会社

Tel : +81 58-247-3190
e-mail : info@gifu-rinei.jp
http://www.rinei-web.jp/

Korea

Fours, Inc.

Tel : +82-31-635-6520
e-mail : jang@fours.co.kr
http://www.fours.co.kr

Luxembourg

Buzaglo BV

Tel : +31 36.521-0100
e-mail : info@buzaglo.nl
http://www.buzaglo.nl

Malaysia

Guan Chow Sdn Bhd

Tel : +60 5.253-1578
e-mail : gccycle@gmail.com
http://www.gccycle.com

Mexico

Bicicletas Mercurio S.A. de C.V.

Tel : +52 444-1442-400
e-mail : contacto@windsorsportsgroup.com
http://www.windsorsportsgroup.com

Netherlands

Buzaglo BV

Tel : +31 36.521-0100
e-mail : info@buzaglo.nl
http://www.buzaglo.nl

New Zealand

H S White & Son Limited

Tel : +64 6.350-2440
e-mail : gillian@hswhite.co.nz
http://www.hswhite.co.nz

Norway

Deler AS

Tel : +47 6498-9950
e-mail : post@deler.no
http://www.deler.no

Peru

Oxford SpA- Sucursal Peru

Tel : +51 21.450-512
e-mail : dbalarezo@oxfordperu.com
http://www.oxfordstore.pe

Philippines

Champ Bike

Tel : +63 905.370-5648
e-mail : champ@chambbikeph.com
https://www.facebook.com/chambbikeph

Poland

Unibike Sp.J.

Tel : +48 52.348-9611~13
e-mail : unibike@unibike.pl
http://www.unibike.pl

Portugal

Ciclo Coimbrões - Joaquim Leite Comércio de Velocípedes, Lda.

Tel : +351 22.370-9772
e-mail : geral@ciclocimbroes.com
http://www.ciclocimbroes.com

Romania

SC Velomania SRL

Tel : +40 031 805 99 06
e-mail : sales@dragzone.ro
http://www.dragzone.ro/

Russia

Maximum company / Компания Максимум

Tel : +7 (812) 740-79-62
e-mail : maximum@msgbox.ru
http://st-peterbike.ru

Singapore

Guan Chow Sdn Bhd

Tel : +60 5.253-1578
e-mail : gccycle@gmail.com
http://www.gccycle.com

Spain

Comet S.L.

Tel : +943 331-393
e-mail : comet@comet.es
http://www.comet.es

Switzerland

VELOK AG

Tel : +41 448386050
e-mail : info@velok.ch
http://www.velok.ch

Taiwan

達陸國際股份有限公司

Tel : +886 4 835 3575
e-mail : dalux.krex@gmail.com
http://www.krex.com.tw

Thailand

Asia International Business & Sales Co., Ltd. / บริษัท เอเชียอินเตอร์เนชั่นแนลบิสเนสแอนด์เซลส์ จำกัด

Tel : +66 2887-7813~4
e-mail : info@asiabike.com
http://www.asiabike.com

Turkey

Kron Bisiklet A.Ş.

Tel : +90 444 27 98
e-mail : info@kronbisiklet.com.tr
http://www.kronbisiklet.com.tr

U.S.A.

Luckybird LLC

Tel : +1(509)-842-8662
e-mail : aidan@luckybirdbrands.com
www.luckybirdbrands.com

UK

Solent (UK) Ltd, T/A Windwave

Tel : +44 23.9252-1912
e-mail : sales@windwave.co.uk
http://www.windwave.co.uk

Ukraine

Veloplaneta Ltd.

Tel : +38 050 402 37 05
e-mail : veloplaneta@gmail.com
http://www.veloplaneta.com.ua

Vietnam

HP Cycles

Tel : +84 0932019931
e-mail : hpcyclesvn@gmail.com
https://hpcycles.vn/



www.icetoolz.com
contact@icetoolz.com



Lifu Bicycle Co., Ltd.

No. 4, Lane 11, Ziqiang Street, Tucheng District
New Taipei City 236043, Taiwan
Tel: +886 2.2268-7367
Fax: +886 2.2268-1947